

PCA4688A

Converter for Connecting 80-pin 0.8mm-pitch QFP to 80-pin 0.8mm-pitch LCC

Function

The PCA4688A is a board for converting 80-pin 0.8mm-pitch QFP (80P6-B or 80P6N-A) to 80-pin 0.8mm-pitch LCC (80D0).

Application

Use the PCA4688A to solder the 80-pin 0.8mm-pitch QFP package MCU, etc. to the foot pattern of the PCA4688A and to insert the PCA4688A into the 80-pin LCC socket on the target.

Dimensions

36.0(D)×40.0(W)×9.0(H)mm

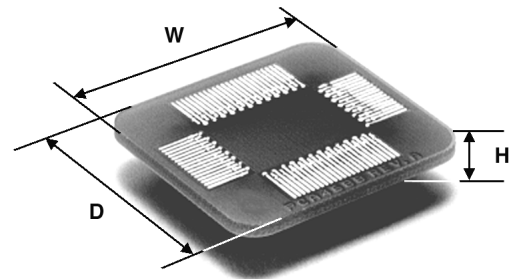

Reference Foot Pattern (Unit: mm)

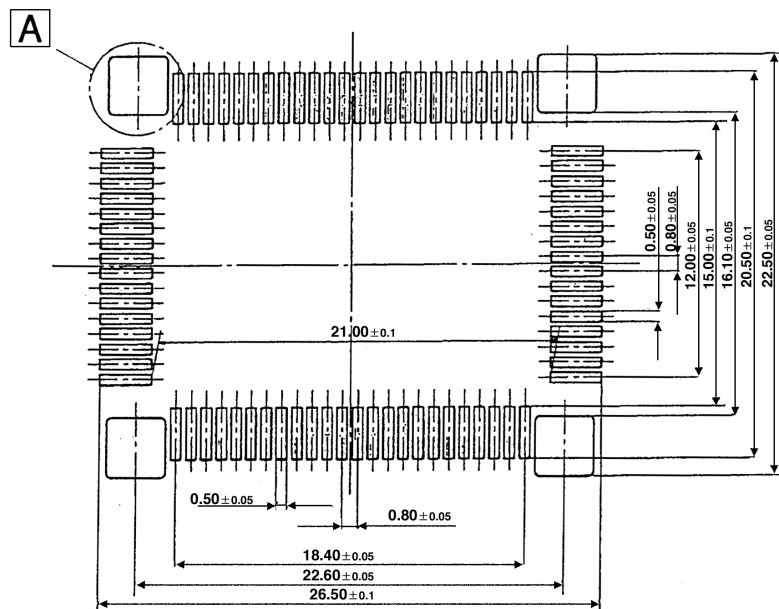

Detailed view of A

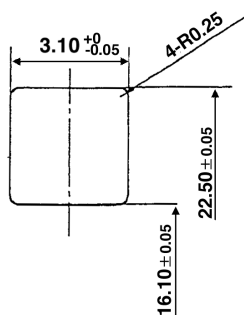

[Ordering Information] See Appendix H "Ordering Information".