

4

3

2

1

D

D

C

C

B

B

A

A

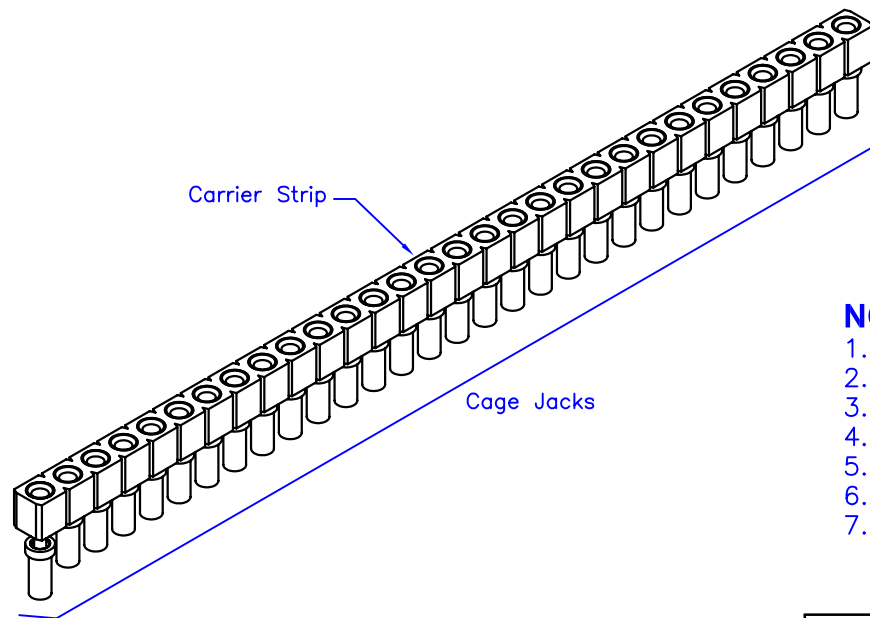
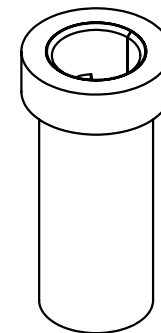
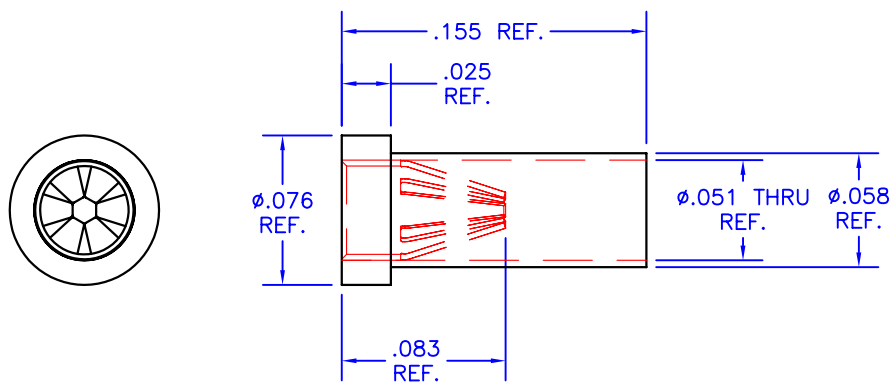

NOTES:

1. Unless otherwise noted, dimensions are in inches.
2. Shell: 360 brass, half-hard, with 200 μ in tin/lead over nickel
3. Contacts: Beryllium copper with 10 μ in gold over nickel
4. Current rating: 4.5 amps, for 10°C temperature rise.
5. Solder mount in minimum .059/.061 diameter mounting hole.
6. Mill-Max Part No. 0305-2-15-01-47-14-10-0
7. This receptacle is supplied on a 30-position carrier strip as Mill-Max part number S 703-93-130-47-050000.

TOLERANCES - UNLESS OTHERWISE SPECIFIED			
DIAMETERS: $\pm .002$			
LENGTHS: $\pm .005$			
ANGLES: $\pm 2^\circ$			



TITLE						PART NO.	
PIN RECEPTACLE FOR .025-.037 DIAMETER PINS						MS11	
SUBJECT							
MECHANICAL DRAWING							
ENG.	TECH/DRAW.	DCA	SH.	OF	FILENAME	REV	DATE
D-M	D-M	46478	1	1	MS11-B	B	10/20/04

4

3

2

1