



FCIconnect.com

Copyright FCI

D

form: A3

1

2 3

4

5

6

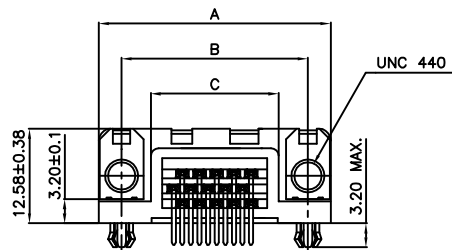
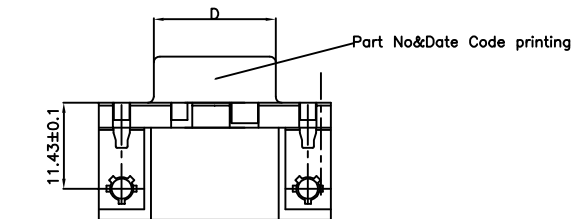

NOTE-1. FOR 14 POSN.HOLE NO.9 IS BLOCKED.

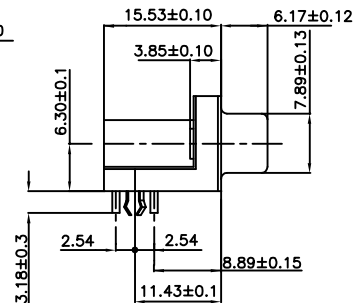

SIZE	DIMENSIONS						
	A±0.38	B±0.12	C±0.10	D ^{+0.25} ₋₀	E	F	G
14/15	30.81	24.99	16.96	16.21	7.68	8.19	2.285
26	39.14	33.32	25.18	24.54	7.02	8.01	2.285
44	53.03	47.04	39.12	38.25	7.01	8.02	2.285
62	69.32	63.50	55.68	54.71	7.03	8.21	2.41

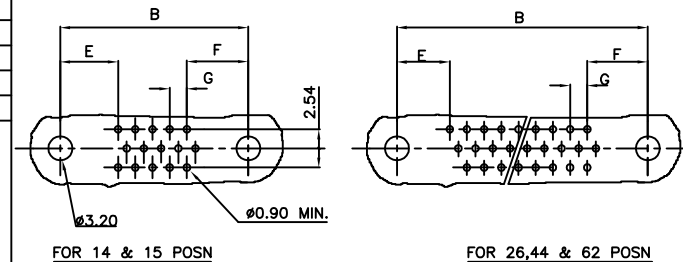
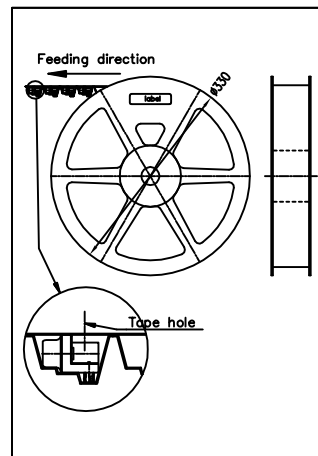

PCB DRILLING DETAILS

TECHNICAL SPECIFICATIONS

MATERIAL

SHELL

: STEEL TIN/Zinc Cr 3 PLATED.

INSULATORS

: SELF EXTINGUISHING THERMOPLASTIC,
UL CLASS94V0

CONTACTS

: COPPER ALLOY

PLATING

ACTIVE ZONE

: GOLD OVER NICKEL

TERMINATION ZONE

: SnPb over Ni

FOR LEAD FREE TERMINATION

: 2 μ MIN.MATTE TIN TOP OVER
1.27 μ MIN.NICKEL UNDER PLATE

METAL BRACKET

: BRASS,TIN/Zinc Cr 3 PLATED.

SCREW LOCK

: BRASS,TIN/Zinc Cr 3 PLATED.

HARPOON

: BRASS,TIN PLATED.

CLINCH NUT

: BRASS,TIN/Zinc Cr 3 PLATED.

ELECTRICAL DATA

MAX.CURRENT RATING

: 3A

TEST VOLTAGE

: 1000V

RATED VOLTAGE

: 300V

CONTACT RESISTANCE

: <25mΩ

SHELL RESISTANCE

: <5mΩ

INSULATION RESISTANCE

: >5000MΩ

ENVIRONMENTAL CHARACTERISTICS

OPERATING TEMPERATURE RANGE

: -55°C +125°C

MECHANICAL CHARACTERISTICS

MATING/UNMATING CYCLES (Min.)

: > μ
> μ

INSERTION/EXTRACTION FORCE PER CONTACTS: 5 N Max./0.3 N Min.

ORDERING INFORMATION

I C D X X S 1 3 E X X X 1 2 L F

SERIES

NO.OF CONTACTS

14,15,26,44 & 62

TYPE OF CONTACTS

S-SOCKET

TYPE OF TERMINATION

13-ANGLED SPILL

PITCH 2.54 USA

FOOT PRINT 8.89 USA

HEIGHT OF TERMINATION

E-3.18 US STANDARD

LEAD FREE

SPECIAL CODE

12->HIGH TEMP+TAPE AND REEL PACKING.

MOUNTING OPTIONS

PA->STANDARD HOLE
 PL->THREADED INSERT M3
 PX->THREADED INSERT UNC 4.40
 PV->FEMALE SCREW LOCK UNC 4.40
 GL->HARPOON+INSERTM3+METAL BRACKET
 GX->HARPOON+INSERT UNC 4.40+METAL BRACKET
 GV->HARPOON+F.SCREW LOCK UNC 4.40+METAL BRACKET
 UL->INSERT M3+METAL BRACKET
 UX->INSERT UNC 4.40+METAL BRACKET
 UV->F.SCREW LOCK UNC 4.40+METAL BRACKET

PLATING

4->FLASH Au+SnPb/Sn
 6->0.76μ Au+SnPb/Sn

Packaging Details

Tape according to EIA-481-B

Material : Conductive type

Reel ø 330mm

Qty for 15 pos- 130nos/ reel

Qty for 26 pos- 110nos/ reel

Empty Pockets

3 pockets min.and 300mm
 extra cover tape at beginning
 and 5 pockets min. at the end.

Final packaging

5 reels/ cartons

mat'l. code				surface	tolerance	projection	product family	
				ISO 1302	ISO 406 ISO 1101		COMPACT D	
ltr	ecn no	dr	date	tolerances unless otherwise specified			title	
D	106-0074	GVJ	2006/06/08	angles	linear		C-D A/S FEMALE CONNECTOR	
				0°±1°		MM		
						scale		
		dr	GEORGE.V.JOSEPH	2004/10/12			dwg no	
		enrg	Elias C. Thomas	2004/10/12			sheet 1 of 1	
		chr	GEORGE.V.JOSEPH	2006/06/23			C-CD-0021	
		appd	K.V.SIVADAS	2006/06/23			size	
sheet	revision	D					type	
index	sheet	1					Product Customer Drawing	

PDM: Rev:D

STATUS: Released

Printed: Jul 06, 2007