

Over Travel Light Touch Switches

Type: **EVQP0**



■ Features

- External dimensions : 6.2 mm×6.2 mm, Height 7.45 mm
- Comfortable for long-time operation due to over-travel
- Excellent light-touch operational feel

■ Recommended Applications

- Operating switches for other electronic equipment
- Operation switches for PC mouse

■ Explanation of Part Numbers

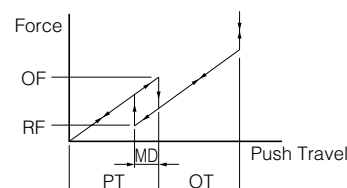
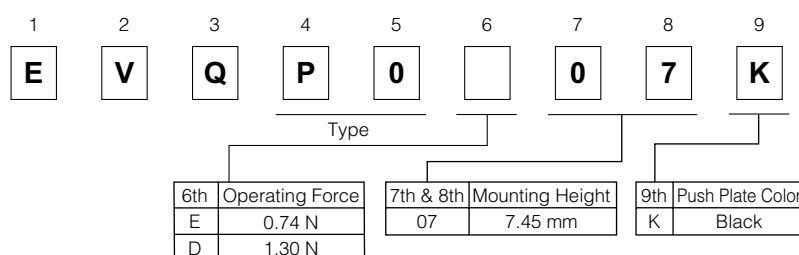

■ Specifications

Type		Snap action / Push-on type SPST	
Electrical	Rating	10 μ A 2 Vdc to 50 mA 30 Vdc (Resistive load)	
	Contact Resistance	100 m Ω max. (1 Ω max. after life test)	
	Insulation Resistance	100 M Ω min. (at 100 Vdc)	
	Dielectric Withstanding Voltage	500 Vac for 1 minute	
	Bouncing	3 ms max. (ON, OFF)	
Mechanical	Operating Force	EVQP0E : 0.74 N max.	EVQP0D : 1.3 N max.
	Returning Force	0.1 N min.	
	Pre-travel	0.5 mm max.	
	Movement Differential (MD)	0.12 mm max.	
	Over Travel	0.2 mm max.	
Endurance	Operating Life	EVQP0E : 5000000 cycles min.	EVQP0D : 1000000 cycles min.
Operating Temperature		-25 °C to +65 °C	
Storage Temperature		-45 °C to +85 °C	
Minimum Quantity/Packing Unit		500 pcs. Polyethylene Bag (Bulk)	
Quantity/Carton		10000 pcs.	

■ Dimensions in mm (not to scale)

EVQP0

(Bulk)

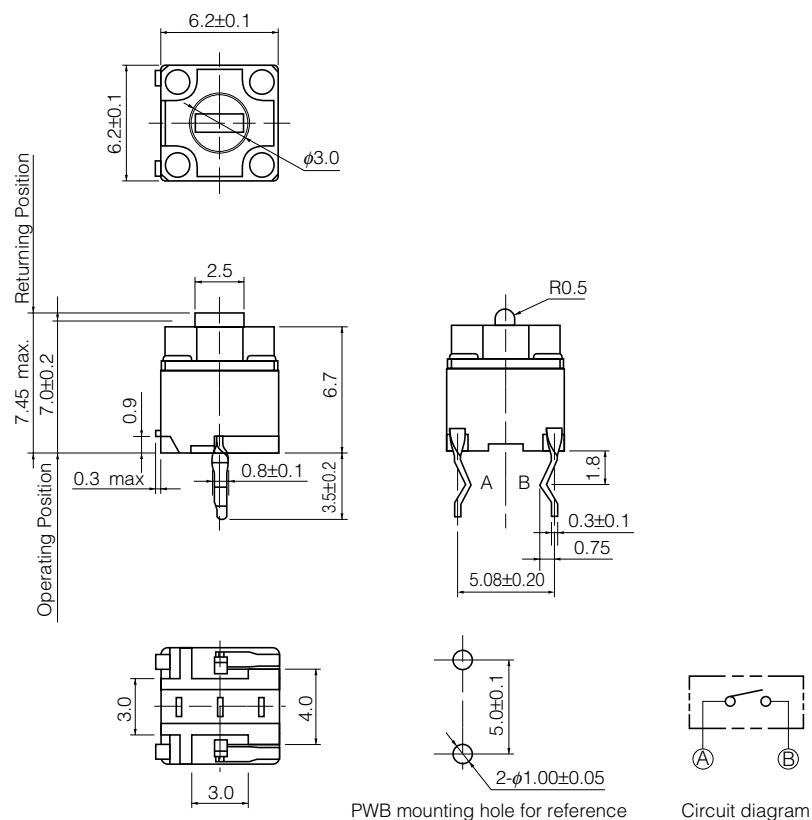

Part Numbers	Operating Force	Height	Push Plate Color	Operating Life
EVQP0E07K	0.74 N	7.45 mm	Black	5000000 cycles
EVQP0D07K	1.30 N	7.45 mm	Black	1000000 cycles