



FCIconnect.com

Copyright FCI

PRODUCT NUMBER
98481-YXXLF

WHEN REQUIRED, ADD SUFFIX LETTER "LF"
INDICATES THE PRODUCT IS RoHS
COMPATIBLE, SEE NOTE 7
NUMBER OF POSITIONS : 02 TO 36

PLATING

3=0.76µm GOLD/GXT ON CONTACT AREA
3.81µm TIN-LEAD ON TAIL

4=3.81µm TIN-LEAD ON CONTACT AREA
AND ON TAIL

WHEN "LF" IS REQUIRED, 2µm MIN
MATTE TIN OVER 1.27µm MIN NICKEL
IS PROVIDED INSTEAD OF TIN-LEAD

NOTES:

1. BODY MATERIAL: POLYESTER 30% GLASSFILLED COLOR BLUE, FLAME RETARDANT PER UL-94 V0.
2. CONTACT MATERIAL: PHOSPHOR BRONZE.
3. 22N MIN PIN RETENTION IN EITHER DIRECTION
4. 0.6 MAX PROTRUSION PERMITTED AT 4 PLACES
5. PACKAGING :
 - POLYBAGS FROM 02 TO 06 POSITIONS
 - TUBE FROM 07 TO 36 POSITIONS
6. TO DETERMINE DIMENSIONS :
N = NUMBER OF POSITIONS PER ROW
EXAMPLE : 8 POS $N \times 2.54 = 20.32\text{mm}$
7. RoHS COMPATIBLE PRODUCT SPECIFICATIONS

- a - PLATING:
 - "LF" MEANS THE PRODUCT IS LEAD-FREE, 2µm MINIMUM MATTE TIN OVER 1.27µm MINIMUM NICKEL UNDERPLATE.
- b - MANUFACTURING PROCESS COMPATIBILITY
 - THE HOUSING WILL WITHSTAND EXPOSURE TO 245°C ±5°C SOLDER BATH TEMPERATURE FOR 5 SECONDS IN A WAVE SOLDER APPLICATION WITH A 1.6mm MIN THICK CIRCUIT BOARD.
- c - LABELING:
 - MEETS PACKAGING SPECS AS PER GS-14-920
- d - LEGAL STATEMENT: SEE GS-22-008

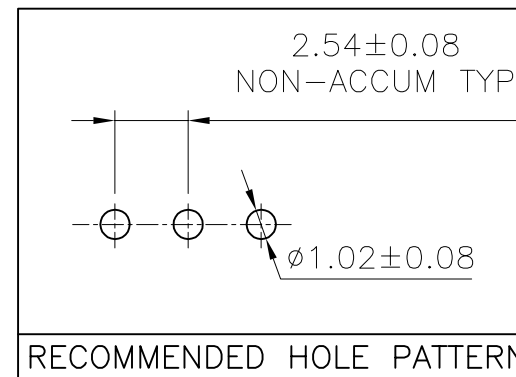
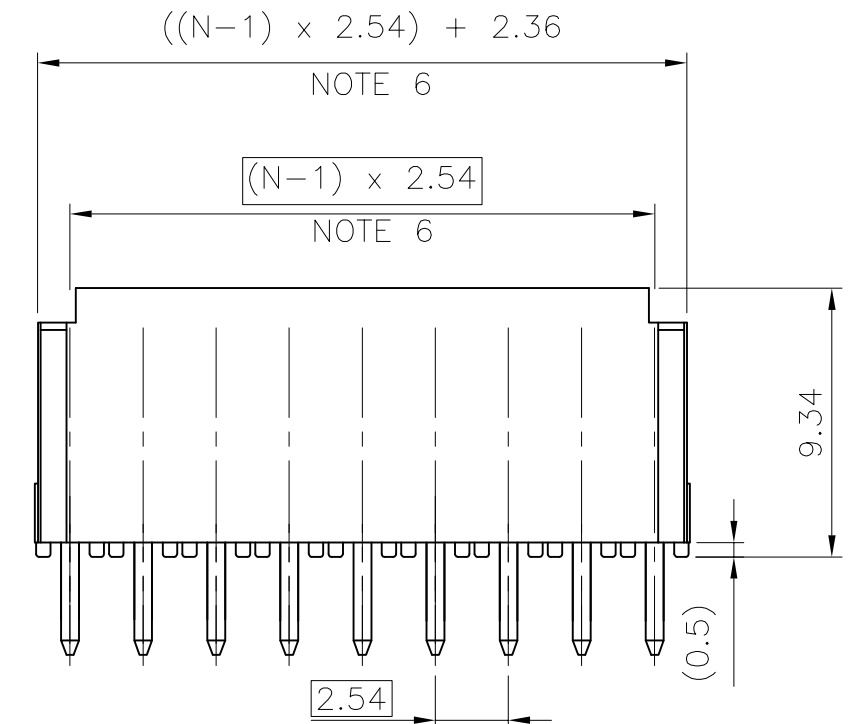
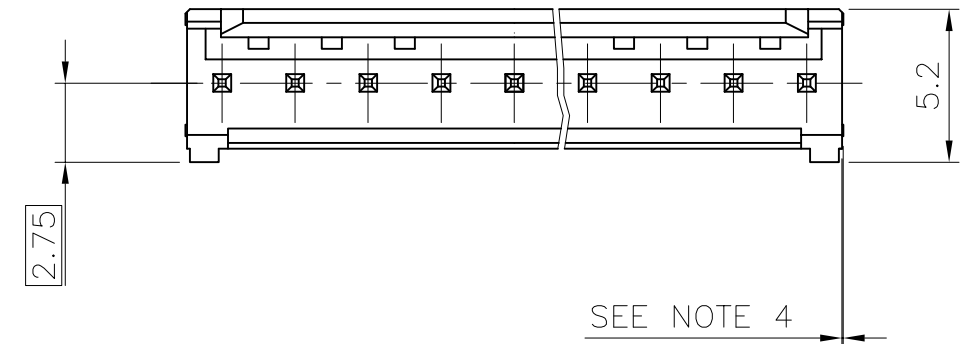
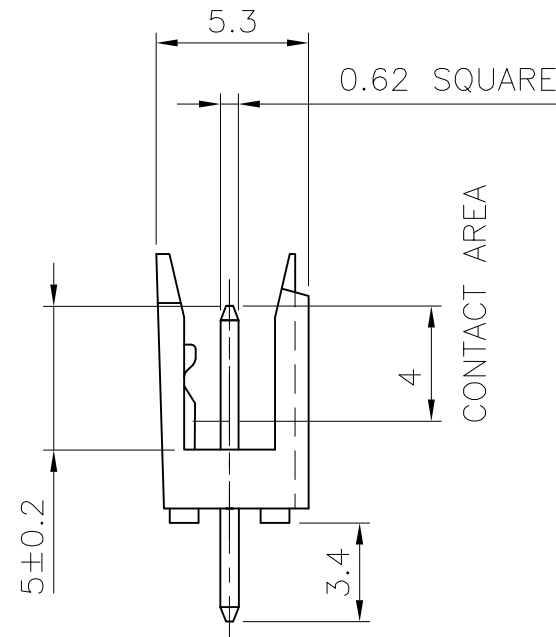

mat'l. code				surface	tolerance	projection	product family			
SEE NOTES				ISO 1302	ISO 406 ISO 1101		DUBOX HDR			
ltr	ecn no	dr	date	tolerances unless	otherwise specified		title			
A	F00190	LMU	00.04.12	angles	.X ±0.3	mm	DUBOX HEADER STRAIGHT, SINGLE ROW			
B	F05-0117	LMU	05.01.26	linear	.XX ±0.15					
C	F05-0244	JCO	05.09.06		.XXX ±0.05	scale 4:1	dwg no			
D	F06-0228	LMU	06.07.11	dr	MULIN.L 00.04.12		sheet 1 of 1			
E	F08-0147	YOV	08.04.14	engr	COMPAGNON.J 00.04.12		size			
				chr			98481			
				appd	JMC 00.04.12		A3			
sheet index				revision	sheet		type			
							CUSTOMER Drawing			

form: A3