

PRODUCT NUMBER
93235-XXX
93235-XXYLF

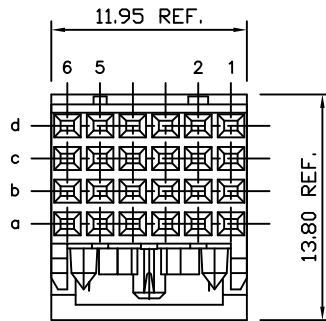
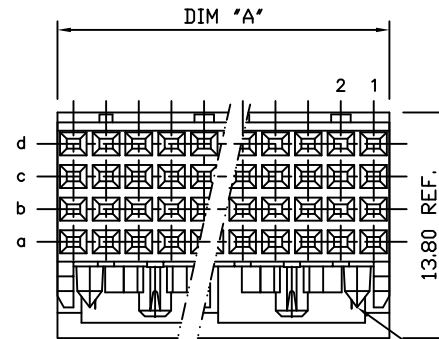

4X6MM -X11, -X12, AND -X13

4X12MM -X21, -X22, AND -X23
4X24MM -X31, -X31S, -X32, AND -X33
4X48MM -X41, -X41S, -X42, AND -X43

NOTE 7

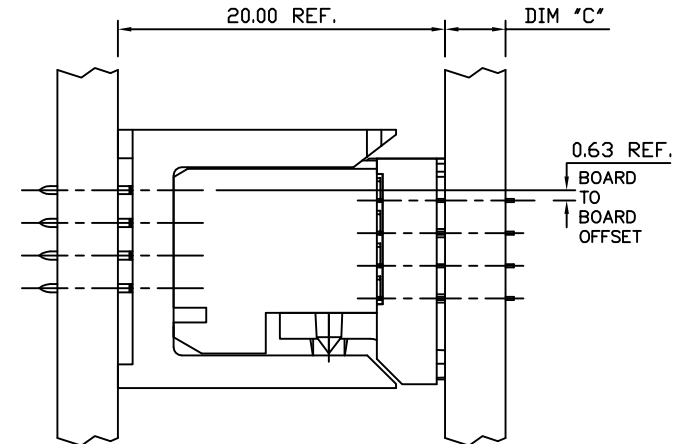
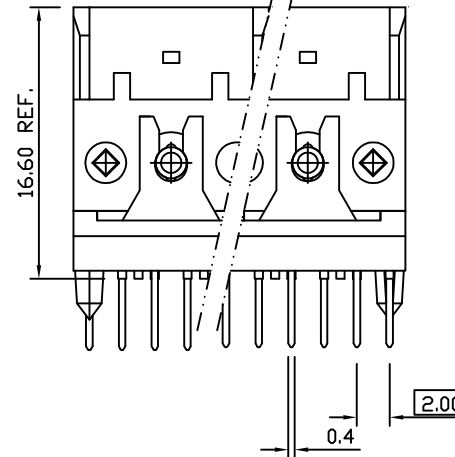
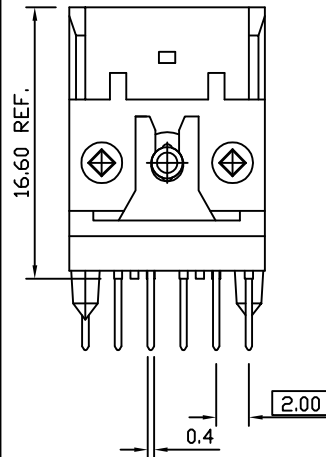
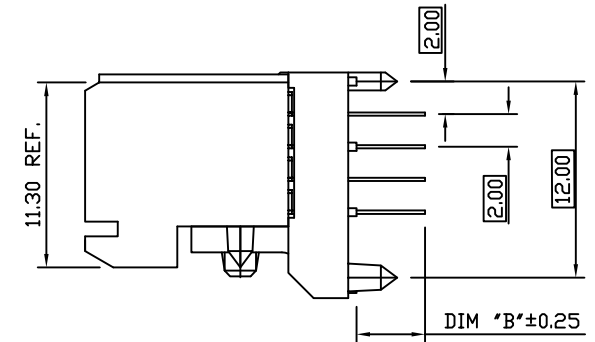

PLATING CONTACT AREA:

DASH NR:	PERFORMANCE LEVEL
-1YY	TELCORDIA CO
-2YY	CUSTOMER SPECIAL
-3YY	CUSTOMER SPECIAL
-9YY	TELCORDIA CO
-1YYLF	TELCORDIA CO
-2YYLF	CUSTOMER SPECIAL
-3YYLF	CUSTOMER SPECIAL
-9YYLF	TELCORDIA CO

mat'l. code SEE NOTES				tolerances unless otherwise specified		CUSTOMER COPY	FCI www.fciconnect.com			
ltr	ecn no	dr	date	linear	.X ±.3	projection	title			
M	DG07-0171	Cenh	05/25/07		.XX ±.10		VERT. SIG. RECEPT ASSY			
N	DG07-0375	Cenh	9/10/07		.XXX ±.050		4x6, 4x12, 4x24, 4x48			
P	DG08-0171	TER	9/3/08	angles	0° ±2°		product family METRAL (tm)			
-	-	-	-	dr	T.BRUNGARD 2/22/03	MM	size		code	
J	V03-0892	TAB	8/15/03	enr	M.GRAY 2/22/03		dwg no		213	
K	V03-0722	LP	8/22/03	chr	M.GRAY 2/22/03	scale	A		sheet	
L	V05-0398	DAI	04/29/30	appd	M.GRAY 2/22/03	1:1	93235		1 of 3	
sheet	revision	P	P	P						
index	sheet	1	2	3						

cage code
22526

ACAD

PDM: Rev:P

STATUS: Released

Printed: Nov 06, 2008

Tous droits strictement reserves. Reproduction ou communication a des tiers
Interdite sous quelque forme que ce soit sans autorisation écrite du propriétaire.
Propriete de c FCI. Droits de reproduction FCI.



All rights strictly reserved. Reproduction or issue to third parties in any
form whatever is not permitted without written authority from the proprietor.
Property of FCI. Copyright FCI.



PRODUCT NUMBER	DIM "A"	TAIL LGTH DIM "B"	PCB THK. DIM "C"
93235-X11	-	2.65	1.6
93235-X21	23.95 REF.	2.65	1.6
93235-X31	47.95 REF.	2.65	1.6
93235-X41	95.95 REF.	2.65	1.6
93235-X31S ⑧	47.95 REF.	2.65	1.6
93235-X41S ⑧	95.95 REF.	2.65	1.6

*SEE NOTE 10 FOR LEAD FREE OPTION

PRODUCT NUMBER	DIM "A"	TAIL LGTH DIM "B"	DIM "C"	ROW	Configuration TERMINAL IN POSITION (X)					
					6	5	4	3	2	1
93235-X14/X14LF	-	3.45	2.4	D	X	X	X	X	X	X
				C	X	X	X	X	X	-
				B	X	X	X	X	X	X
				A	X	X	X	X	X	X

"-" POSITION NOT LOADED
"X" POSITION LOADED

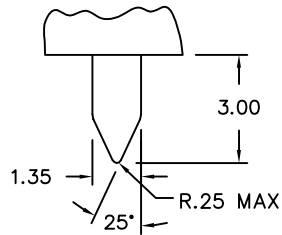

VIEW E, NOTE 8
SCALE 2:1

PRODUCT NUMBER	DIM "A"	TAIL LGTH DIM "B"	PCB THK. DIM "C"
93235-X12	-	3.45	2.4
93235-X22	23.95 REF.	3.45	2.4
93235-X32	47.95 REF.	3.45	2.4
93235-X42	95.95 REF.	3.45	2.4

PRODUCT NUMBER	DIM "A"	TAIL LGTH DIM "B"	PCB THK. DIM "C"
93235-X13	-	4.25	3.2
93235-X23	23.95 REF.	4.25	3.2
93235-X33	47.95 REF.	4.25	3.2
93235-X43	95.95 REF.	4.25	3.2

NOTES:

- BODY MATERIAL: LCP 30% GLASS
FLAME RETARDANT ACC. UL 94-V0
- TERMINAL MATERIAL: PHOSPHOR BRONZE
- PLATING SOLDER TAILS
93237-XXX 1.0-2.0 μ m SnPb TIN LEAD
93237-XXYLF 1.0-2.0 μ m Sn (LEAD FREE)
- APPLICATION SPECIFICATIONS:
BUS-20-059
GS-20-001
- PRODUCT MARKING: (PART NUMBER & LOT CODE).
- INDICATED HOLES ARE UNPLATED
- AND BATCH I.D.
- ⑦ DIAMOND LOCATION PEG ARE ONLY EXISTED ON THE BOTH SIDES OF PRODUCT.
- ⑧ PRODUCT WITH AN "S" SUFFIX WILL HAVE
A SPECIAL ALIGNMENT POST AS SPECIFIED
PER DETAIL E, SHEET 2.
EXAMPLE/LEAD FREE OPTION: 93235-XXYSLF
- THESE PRODUCTS WHERE PART NUMBERS ENDS IN "LF"
MEET THE EUROPEAN UNION DIRECTIVES AND OTHER
COUNTRY REGULATIONS AS DESCRIBED IN GS-22-008.
- ⑩ FOR LEAD FREE PART NUMBERS ADD "LF" SUFFIX. EXAMPLE 93235-XXYLF
- ALL PRODUCTS WILL WITHSTAND EXPOSURE TO 240°C FOR 60 SECONDS
IN A CONVECTION, INFAR-RED OR VAPOR PHASE REFLOW OVEN.

mat'l. code SEE NOTES				tolerances unless otherwise specified		CUSTOMER COPY	FCI www.fciconnect.com			
ltr	ecn no	dr	date	linear	.X \pm .3 .XX \pm .10 .XXX \pm .050 0' \pm 2'		projection	title		
P				angles				VERT. SIG. RECEIPT ASSY 4x6, 4x12, 4x24, 4x48		
				dr	T.BRUNGARD 2/22/03			product family METRAL (tm)		
				enr	M.GRAY 2/22/03			size dwg no		
				chr	M.GRAY 2/22/03			A 93235		
				appd	M.GRAY 2/22/03		scale 1:1			
sheet index	revision sheet									

cage code
22526

A

B

[illegible]

www.fciconnect.com

VERT. SIG. RECEPT ASSY
4x6, 4x12, 4x24, 4x48

product family	METRAL (tm)
----------------	-------------

size	dwg no
------	--------

A	93235
---	-------

--	--	--	--	--	--	--	--

cage code	22526
-----------	-------

STATUS: **Released** Printed: Nov 66, 2008