

PRODUCT NO.  
SEE SHT. 2

SIZE	DIM H	DIM L	DIM W
1 X 4	.300/7.62	1.291/32.79	_____
1 X 6	.300/7.62	1.291/32.79	_____
1 X 8	.300/7.62	1.291/32.79	_____
1 X 10	.300/7.62	1.291/32.79	_____
2 X 3	.705/17.91	1.267/32.18	.560/14.22
2 X 4	.705/17.91	1.267/32.18	.660/16.76
2 X 6	.735/18.67	1.365/34.67	.860/21.84
2 X 8	.735/18.67	1.365/34.67	1.060/26.92
2 X 10	.735/18.67	1.365/34.67	1.260/32.00

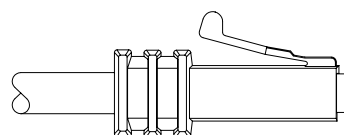

DOUBLE ROW PLUG ASSEMBLY

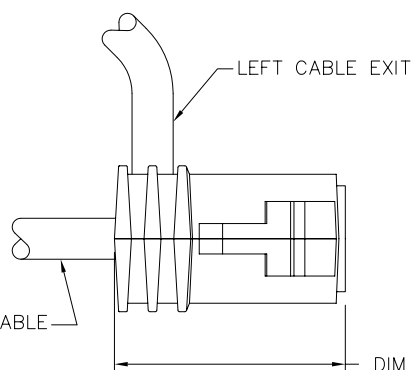
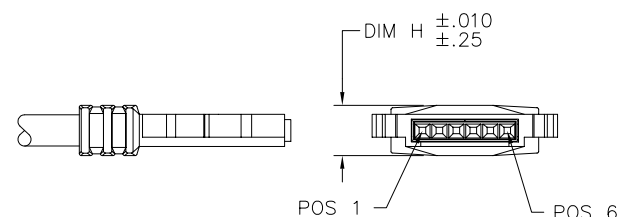
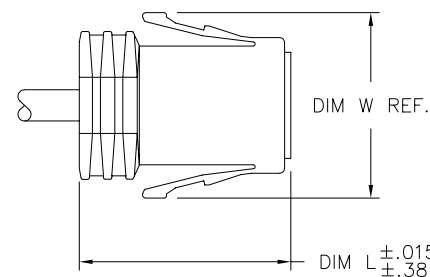
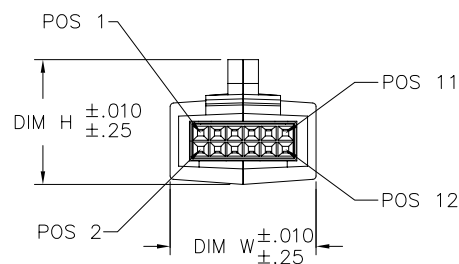

SINGLE ROW PLUG ASSEMBLY

mat'l. code				surface ISO 1302	tolerance ISO 406 ISO 1101	projection INCH/MM	product family LATCH-N-LOK
ltr	ecn no	dr	date	tolerances unless otherwise specified		scale 1:1	title <b>LATCH-N-LOK CONNECTOR KIT</b>
J	V90581	CGC	2/25/99	angles	.XX±.01/.3		
K	V90628	CGC	3/15/99	linear	.XXX±.005/.13		
L	V01758	TFG	8/23/00	0°±2°	.XXXX±.0020/.051		
M	V03-0798	HTB	7/16/03	dr	D. INGRAM	5/13/96	dwg no <b>91481</b> sheet 1 of 3 size A3
N	M05-0062	ERE	4/01/05	enrg	M. SMYK	5/13/96	
P	M06-0151	MHT	4/10/06	chr	M. SMYK	5/13/96	
R	M06-0365	AGS	9/21/06	appd	M. SMYK	5/13/96	
sheet	revision	R	R	R			type Product Customer Drawing
index	sheet	1	2	3			



FCIconnect.com

Copyright FCI

PRODUCT NUMBER  
SEE TABLE

914VW-XYZLF

LEAD FREE OPTION ⑨ ⑩

Y	COLOR PLUG AND CAP	
1	LIGHT GRAY	OBSOLETE
2	OFF-WHITE	
3	DARK GRAY	OBSOLETE
4	BLACK	
5	SLATE GRAY	OBSOLETE
7	SILVER GRAY	
8	PEARL WHITE	OBSOLETE
9	PEBBLE GRAY	

NOTE 6

Z	CABLE EXIT STYLE
0	NO EXIT
1	REAR EXIT
2	RIGHT EXIT
3	LEFT EXIT

NOTE 5

X	SIZES 2X3 & 2X4 CABLE O.D.	SIZES 2X6, 2X8 & 2X10 CABLE O.D.	SIZES 1X4, 1X6, 1X8 & 1X10 CABLE O.D.
0	.040/1.02 TO .065/1.65	.145/3.86 TO .165/4.19	.045/1.14 TO .075/1.91
1	.070/1.78 TO .095/2.41	.170/4.32 TO .195/4.95	.080/2.03 TO .095/2.41
2	.100/2.54 TO .125/3.18	.200/5.08 TO .225/5.72	.100/2.54 TO .115/2.92
3	.130/3.30 TO .155/3.94	.230/5.84 TO .255/6.48	.120/3.05 TO .135/3.43
4	.160/4.06 TO .185/4.70	.260/6.60 TO .285/7.24	.140/3.56 TO .155/3.94
5	.190/4.83 TO .215/5.46	.290/7.34 TO .315/8.00	.160/4.06 TO .175/4.45
6	.220/5.59 TO .245/6.22	NA	.180/4.57 TO .195/4.95
7	.250/6.35 TO .275/6.99	NA	NA
8	NO EXIT HOLE	NO EXIT HOLE	NO EXIT HOLE

W	SIZE CONFIGURATION
1	1 X 4
2	1 X 6
3	1 X 8
4	1 X 10
5	2 X 3
6	2 X 4
7	2 X 6
8	2 X 8
9	2 X 10

V	WIRE SIZE
6	LATCH GUARD (PV'S NOT INCLUDED)
7	
8	PV'S NOT INCLUDED

NOTE 7

## EXAMPLE

91486-541 - IS A 2 X 4 REAR EXIT PLUG IN BLACK WITH A CABLE EXIT HOLE SIZE OF .220/5.59 DIA. (Ø.190/4.83 TO Ø.215/5.46 CABLE RANGE).

mat'l. code				surface ISO 1302 ✓	tolerance ISO 406 ISO 1101	projection 	product family LATCH-N-LOK
ltr	ecn	no	dr	date	tolerances unless otherwise specified	INCH/MM 	title LATCH-N-LOK CONNECTOR KIT
R					angles linear 0°±2'		
						scale 1:1	
			dr	D. INGRAM	5/13/96		dwg no 91481 sheet 2 of 3 size A3
			enr	M. SMYK	5/13/96		
			chr	M. SMYK	5/13/96		
			appd	M. SMYK	5/13/96		
sheet index	revision sheet						type Product Customer Drawing

form: A3

1

2 3

4

5

6

PRODUCT NUMBER  
SEE SHT. 2

## NOTES:

1. EACH KIT CONTAINS ONE EACH OF THE FOLLOWING COMPONENTS:  
LATCH-N-LOK PLUG NOTE 8  
LATCH-N-LOK CAP  
STEP MINI-LATCH HOUSING  
SHIELD CAN  
CRIMP RING
2. COMPONENTS ARE BULK PACKAGE WITH 100 PC OF A COMPONENT PER BAG. PV'S MUST BE ORDERED SEPARATELY.
3. MATERIALS USED: PLUGS AND CAPS ARE MOLDED IN POLYCARBONATE. THE STEP MINI-LATCH HOUSING IS MOLDED IN NYLON, COLOR IS BLACK. THE CRIMP RING IS 304 STAINLESS STEEL, 1/2 HARD. THE SHIELD CAN IS 1/2 HARD BRASS, PLATED WITH 100-150 $\mu$ "/2.54-4.06 $\mu$  OF TIN.
4. PLUGS, CAPS, MINI-LATCH HOUSING AND SHIELD CANS ARE ALL U.L. RECOGNIZED AND CSA APPROVED COMPONENTS.
5. SINGLE ROW CONNECTORS WITH REAR CABLE EXITS ARE CONSIDERED STANDARD PRODUCTS. SINGLE ROW CONNECTORS WITH SIDE CABLE EXITS ARE "CUSTOMER SPECIALS" AND INCLUDE A NYLON TIE WRAP REPLACING THE CRIMP RING (NORMAL CORD RETENTION WILL BE REDUCED AS A RESULT).
6. PLUG AND CAP COLORS LISTED ARE LOW GLOSS FINISH.
7. LATCH GUARD TOOLED IN 2 X 4 SIZE ONLY. THESE KITS DO NOT INCLUDE PV TERMINALS.
8. PLUG TOOLING WITH NO EXIT HOLE AVAILABLE IN 2 X 3, 2 X 4, AND 2 X 6 SIZES ONLY.
9. ADD LF SUFFIX AT THE END OF PART NUMBER FOR LEAD FREE OPTION.
10. THIS PRODUCT MEETS EUROPEAN UNION DIRECTIVES AND OTHER COUNTRY REGULATION AS DESCRIBED IN GS-22-008.

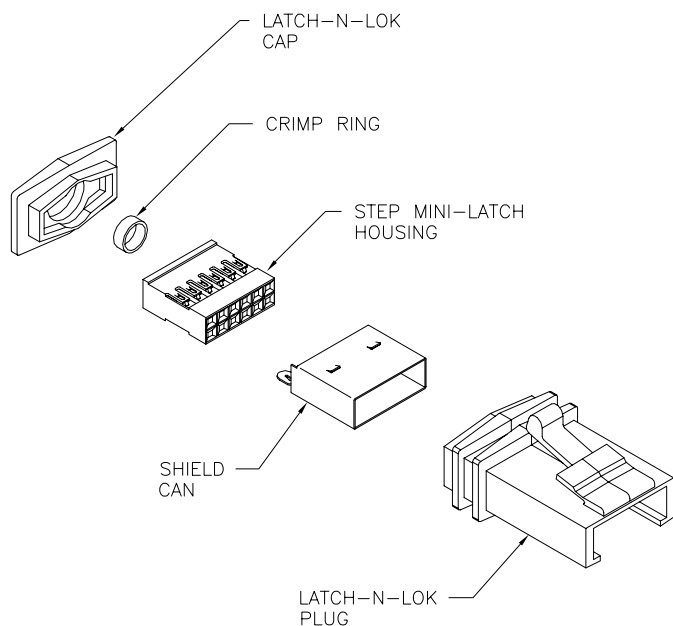

mat'l. code				surface ISO 1302 ✓	tolerance ISO 406 ISO 1101	projection INCH/MM	product family LATCH-N-LOK			
ltr	ecn no	dr	date	tolerances unless otherwise specified		scale 1:1	title LATCH-N-LOK CONNECTOR KIT			
R				angles	linear .XX±.01/.3		dwg no 91481			
				0'±2'	linear .xxx±.005/.13 .xxxx±.0020/.051					
				dr	D. INGRAM	5/13/96	sheet 3 of 3 size			
				enr	M. SMYK	5/13/96	A3			
				chr	M. SMYK	5/13/96				
				appd	M. SMYK	5/13/96	type Product Customer Drawing			
sheet index	revision sheet									

form: A3

1

2

3

4

5

6