

RECOMMENDED MOUNTING HOLE LAYOUT

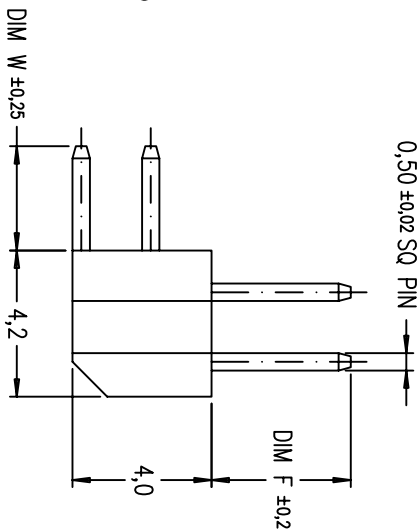

CONFIDENTIAL

mat'l. code			surface		tolerance		projection		product family	
litr	ecm no	dr	date	ISO 1302	ISO 406	ISO 1100	ISO 1302	ISO 406	ISO 1100	MINITEK
L	S8-243	BSL	11/2/98							
M	S90075	BSL	4/30/99							
N	S90177	BSL	9/27/99							
P	S10062	JPEH	4/25/01							
R	S04-0278	KBM	1/7/05	engr	JPEH	4/25/01				
S	S06-0243	KHL	7/20/06	chr	KH LEE	7/20/06				
sheet	revision	S	S	S	S	S				
index	sheet	1	2	3						



MINITEK II
R/A HEADER HTP

90516

dwg no sheet 1 of 3 size
type Product Customer Drawing

PRODUCT NO	POS	POL. POS	DIM X	DIM Y	DIM F	DIM W	PLATING	HSG COLOR
90516-001	2X22	20	42	44	4.0	2.5	0.38um MIN GXT	BEIGE
-002	2X3	6	4	6	4.0	3.0	0.76um MIN GXT	BEIGE
-003	2X10	8	18	20	4.0	3.0	0.76um MIN GXT	BEIGE
-004	2X12	8	22	24	4.0	3.0	0.76um MIN GXT	BEIGE
-005	2X6	8	10	12	4.0	3.0	0.76um MIN GXT	BEIGE
-006	2X10	3	18	20	4.0	2.45	0.38um MIN GXT	BEIGE
-007	2X6	-	10	12	3.4	2.5	0.76um MIN GXT	BEIGE
-008	2X6	2	10	12	4.0	2.5	0.76um MIN GXT	BEIGE
-009	2X3	-	4	6	4.0	2.5	0.76um MIN GXT	BEIGE
-010	2X10	-	18	20	4.0	2.5	0.76um MIN GXT	BEIGE
-011	2X2	3	2	4	4.0	2.5	0.76um MIN GXT	BEIGE
-012	2X2	1	2	4	4.0	3.0	0.76um MIN GXT	BEIGE
-013	2X5	3, 8	8	10	4.0	3.0	0.76um MIN GXT	BEIGE
-014	2X15	20	28	30	4.0	3.0	0.38um MIN Au	BEIGE
-015	2X3	-	4	6	4.0	2.0	0.2um MIN Au	BEIGE
-016	2X15	-	28	30	4.0	2.0	0.2um MIN Au	BEIGE
-017	2X4	-	6	8	4.0	2.5	0.76um MIN Au	BEIGE
-018	2X5	-	8	10	4.0	2.5	0.76um MIN Au	BEIGE
-019	2X23	5,6,11,12,17,18,23,24 29,30,35,36,41,42	44	46	4.0	3.0	0.76um MIN GXT	BEIGE
-020	2X3	4	4	6	4.0	2.5	0.76um MIN Au	BEIGE
-021	2X4	4	6	8	4.0	2.5	0.76um MIN Au	BEIGE
-022	2X5	5, 6	8	10	4.0	3.0	0.76um MIN GXT	BEIGE
-023	2X7	8	12	14	4.0	3.0	0.76um MIN GXT	BEIGE
-024	2X7	8	12	14	4.0	3.0	0.38um MIN GXT	BEIGE
-025	2X20	-	38	40	1.8	2.5	0.76um MIN GXT	BLACK



FCIconnect.com

CONFIDENTIAL

mat'l. code		surface		tolerance		projection		product family	
ISO 1302		ISO 406		ISO 1101				MINITEK	
tolerances unless otherwise specified		angles		linear		MM		title	
S		linear		±0.25		scale 5:1		MINITEK II	
dr		JPEH		4/25/01		dwg no		sheet 2 of 3	
engr		JPEH		4/25/01		90516		size A	
chr		KH LEE		7/20/06		type		Product Customer Drawing	
appd		JOEY NG		7/20/06					
sheet index		revision sheet							

PRODUCT NO	POS	POL. POS	DIM X	DIM Y	DIM F	DIM W	PLATING	HSG COLOR
90516-026	2X22	34	42	44	4.0	2.5	0,38um MIN Au	BLACK
-027	2X22	34	42	44	4.0	3.0	0,38um MIN Au	BLACK

NOTES

1 MATERIAL

BODY : G.F. PCT UL 94V-0 COLOR REFER TO TABLE.

PIN : PHOSPHOR BRONZE

2 GENERAL TOLERANCE ± 0,25

3 POLARISED POSITION REFER TO TABLE.

4 DIM 1,0 APPLIES TO MOLDED SIDE(S) ONLY. IF SIDE(S)

ARE SAW, DIM 0,5 MIN APPLIES.

5 RECESS APPLIES TO MOLDED SIDE(S) ONLY.

6 PRODUCT DESCRIPTION CODE :

XXXX-XXLF

LEAD FREE 7
EXTENSION NUMBER
BASE NUMBER

7 P/N: 90516-XXXX IS SAME AS P/N: 90516-XXX. THE SUFFIX 'LF' IS ADDED JUST FOR EASY LEAD FREE IDENTIFICATION

8 THE HOUSING WILL WITHSTAND EXPOSURE TO 255° C PEAK TEMPERATURE FOR 10 SECONDS IN A CONVECTION, INFRA-RED OR VAPOR PHASE REFLOW OVEN.

9 THE HOUSING WILL WITHSTAND EXPOSURE TO 260° C PEAK TEMPERATURE FOR 10 SECONDS IN A WAVE SOLDER APPLICATION WITH A 1.57MM MINIMUM THICK CIRCUIT BOARD.

10 THIS PRODUCT MEETS EUROPEAN UNION DIRECTIVES AND OTHER COUNTRY REGULATIONS AS DESCRIBED IN GS-22-008.



FCIconnect.com

Copyright FCI

CONFIDENTIAL

mat'l. code				surface		tolerance		projection		product family	
litr	ecr	no	dr	date	ISO 1302	ISO 406	ISO 1101	ISO 1101	MM	MINITEK	MINITEK
S					tolerances unless otherwise specified						
					angles	linear	±0.25				
					dr	JPEH	4/25/01				
					engr	JPEH	4/25/01				
					chr	KH LEE	7/20/06				
					appd	JOEY NG	7/20/06				
sheet	revision									dwg no	sheet 3 of 3
index	sheet									90516	size A
										type	Product Customer Drawing

