

Manufacturer's code

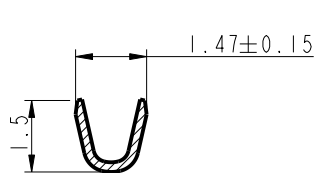

SECTION A-A

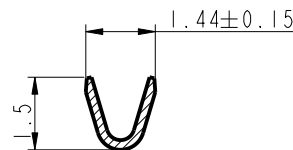

SECTION B-B

NOTES:

- 1-Material:phosphor bronze,thickness 0.20
- 2-Finish on contact area:see table
finish on termination:bright tin lead over nickel
- 3-Wire range:24 to 28 AWG
- 4-Max outer dia of wire insulator:1.02 mm
- 5-Current carrying capacity per contact:
 - 3.Amps max when crimped to #24 AWG
 - 2 Amps max when crimped to #26 AWG
 - 1 Amps max when crimped to #28 AWG
- 6-After 5 insertions into connector,
contact retention must be 5 pounds axial load min
- 7-When contact is crimped to 24 AWG,the insulation
support crimped height must be 1.78 mm max to ensure
a proper insertion into housing
- 6-Packaging:Reel of 5000 contacts

NOTE : ROHS INFORMATIONS

The LF products meet European union directives and other
country regulations as described in GS-22-008
Terminations plating spec : 2um Nickel min + 2um Sn min
Packaging Spec : see GS-14-920

PART NUMBER	Plating
8656451067LF	0.4μ Au
8656451067	0.4μ Au

www.fciconnect.com				surface - ISO 1302	tolerance std ISO 406 ISO 1101	projection mm		
				TOLERANCES UNLESS OTHERWISE SPECIFIED				
Dr	C JARRY	28/01/97		ANGULAR	LINEAR	0.X ±0.3	size A3	Scale 10:1
Eng				0° ±2°		0.XX ±0.1		
Chr						0.XXX ±0.05	ECN	LS08-0127
Appr				Product family		-	Spec ref	
				title		dwg no		Rev.
				CRIMP SOCKET		C01-8656-0418		D
				#Wire 24-28 Ø1.02 max				
				catalog no		Y		sheet 1 of 1

rev	ecn no	dr	date
C	LS06-196	MPE	27/11/2006
D	LS08-0127	MPE	13/05/2008
-	-	-	-
-	-	-	-
-	-	-	-
-	-	-	-

REV F - 2006-04-17



Copyright FCI.