

SECTION A-A

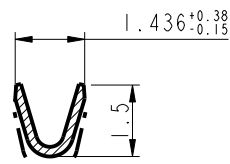

SECTION B-B

# NOTES:

- 1-Material:phosphor bronze,thickness 0.20
- 2-Finish on contact area:see table  
finish on termination:bright tin lead over nickel
- 3-Wire range:24 to 28 AWG
- 4-Max outer dia of wire insulator:1.02 mm
- 5-Current carrying capacity per contact:  
3.Amps max when crimped to #24 AWG  
2 Amps max when crimped to #26 AWG  
1 Amps max when crimped to #28 AWG
- 6-After 5 insertions into connector,  
contact retention must be 5 pounds axial load min
- 7-When contact is crimped to 24 AWG,the insulation  
support crimped height must be 1.78 mm max to ensure  
a proper insertion into housing
- 6-Packaging:Reel of 400 contacts

## NOTE : ROHS INFORMATIONS

The LF products meet European union directives and other  
country regulations as described in GS-22-008

Terminations plating spec : 2um Nickel min + 2um Sn min

Packaging Spec : see GS-14-920

PART NUMBER	PLATING
86563004065LF	0.76μ Au
86563004065	0.76μ Au
86563004064LF	Flash Au
86563004064	Flash Au

www.fciconnect.com		surface - <input checked="" type="checkbox"/> ISO 1302	tolerance std <input checked="" type="checkbox"/> ISO 406 ISO 1101	projection	mm
		TOLERANCES UNLESS OTHERWISE SPECIFIED			
Dr	C JARRY	28/01/97	ANGULAR	size A3	Scale 10:1
Eng			LINEAR		
Chr			0° ±2°		
Appr			0.X ±0.3		
			0.XX ±0.1		
			0.XXX ±0.05		
		Product family	-	ECN	LS08-0167
		Spec ref	-		
		title	CRIMP SOCKET		Rev. F
		#Wire	24-28 Ø1.02 max		
		catalog no	-	customer	sheet 1 of 1
		dwg no	C01-8656-0426		

rev	ecn no	dr	date
D	LS06-196	MPE	27/11/2006
E	LS08-0127	MPE	13/05/2008
F	LS08-0167	MPE	2008/08/05
-	-	-	-
-	-	-	-
-	-	-	-
-	-	-	-

REV F - 2008-04-17