

PRODUCT NUMBER
76345-YXX-XXLF

WHEN REQUIRED, ADD SUFFIX LETTER "LF"
INDICATES THE PRODUCT IS RoHS COMPLIANT
& COMPATIBLE, SEE NOTE 7

TOTAL NB OF POSITIONS 04 TO 72

PIN STYLE SEE SHEET 2

PLATING SEE SHEET 2

NOTES:

1. HOUSING MAT'L : HIGH TEMPERATURE THERMOPLASTIC. UL94V-0 COLOR: BLACK
2. PIN MATERIAL : PHOSPHOR BRONZE
3. DIM $1.27^{+0.03}_{-0.13}$ FOR MOULDED SIDE(S) ONLY. IF SIDE(S) ARE BROKEN, DIM 1.02 TO 1.7 MAX APPLIES.
4. PRODUCT PACKAGED IN POLY BAGS.
5. 12N MIN RETENTION IN EITHER DIRECTION
6. TO DETERMINE DIMENSIONS :
N = NUMBER OF POSITIONS PER ROW
EXAMPLE : 8 POS $N \times 2.54 = 20.32\text{mm}$
7. RoHS COMPATIBLE PRODUCT SPECIFICATIONS
 - a - MANUFACTURING PROCESS COMPATIBILITY
 - THE HOUSING WILL WITHSTAND EXPOSURE TO $260^{\circ}\text{C} \pm 5^{\circ}\text{C}$ SOLDER BATH TEMPERATURE FOR 5 SECONDS IN A WAVE SOLDER APPLICATION WITH A 1.6mm MIN THICK CIRCUIT BOARD.
 - b - LABELLING:
 - MEETS PACKAGING SPECS AS PER GS-14-920
 - c - LEGAL STATEMENT : SEE GS-22-008

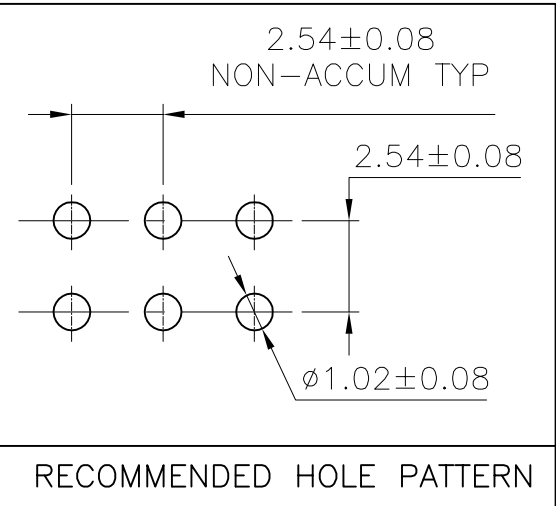
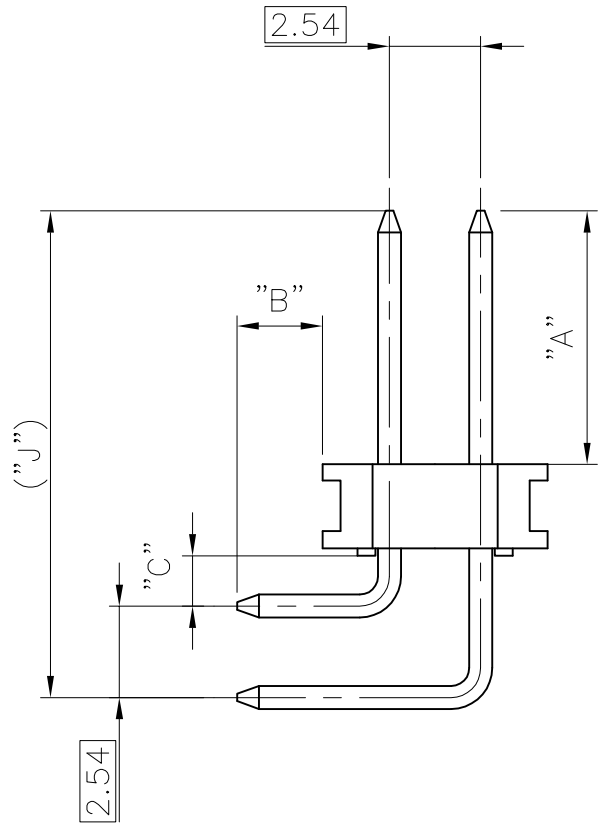
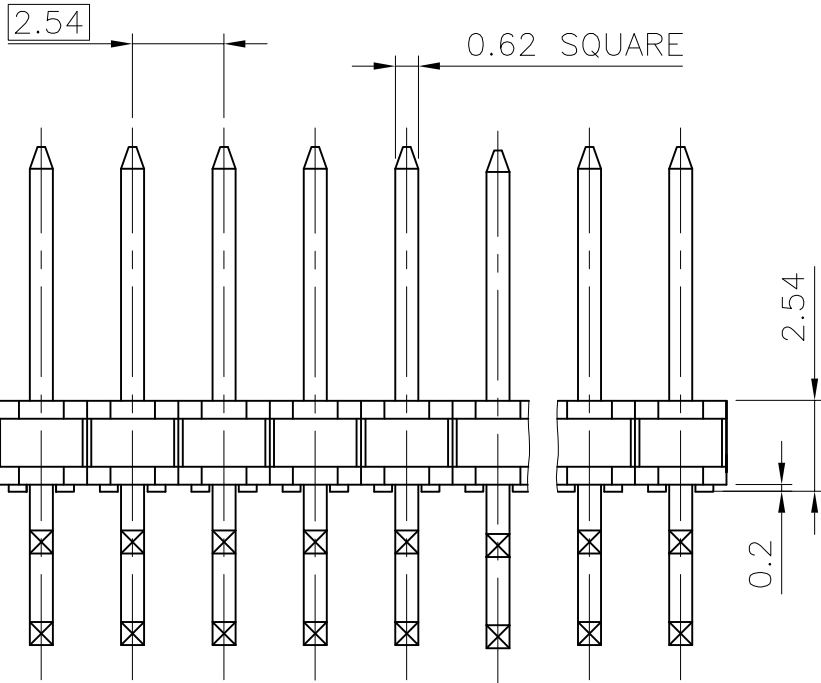
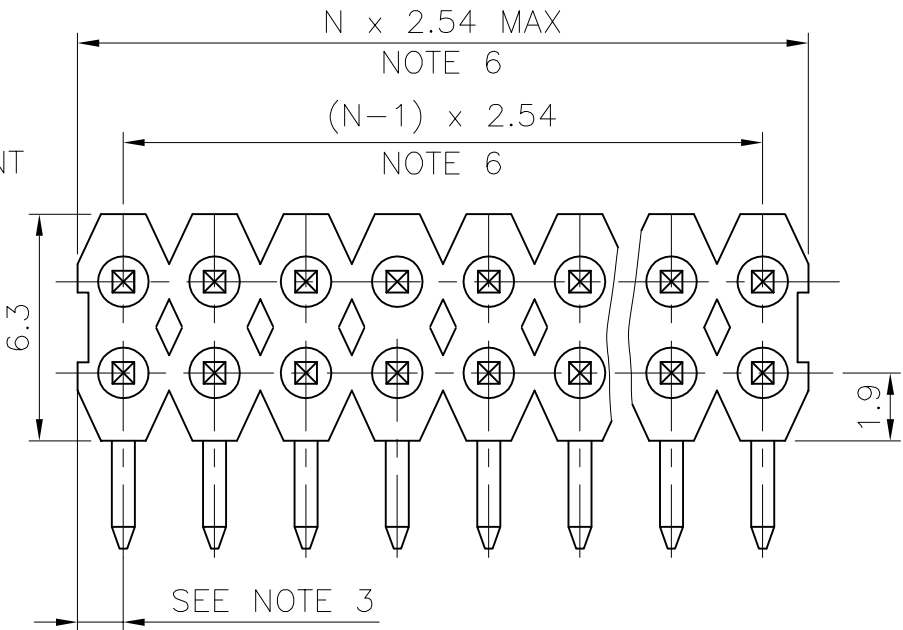

mat'l. code SEE NOTES				surface ISO 1302	tolerance ISO 406 ISO 1101	projection mm	product family BSTIK			
ltr	ecn no	dr	date	tolerances unless	otherwise specified		title HEADER RA,DR, WIDE BODY,2.54mm			
L	F10407	JMC	91.05.24	angles	.X ±0.3		dwg no 76345			
M	F50646	JMC	95.08.30	linear	.XX ±0.15					
N	F05-0186	LMU	05.05.31		.XXX ±0.05	scale 5:1	sheet 1 of 2			
P	F06-0207	LMU	06.07.27	dr	COMPAGNON J	95.08.29	size A3			
R	F08-0148	JCO	08.05.27	engr	JMC	95.08.30				
				chr	JMC	95.08.30	type CUSTOMER Drawing			
				appd	JMC	95.08.30				
sheet index	revision	R	R							
	sheet	1	2							

