

PRODUCT NO
SEE TABLE

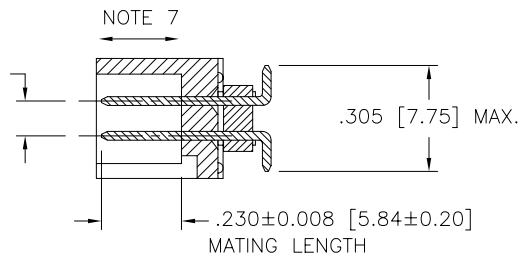

SECTION A-A

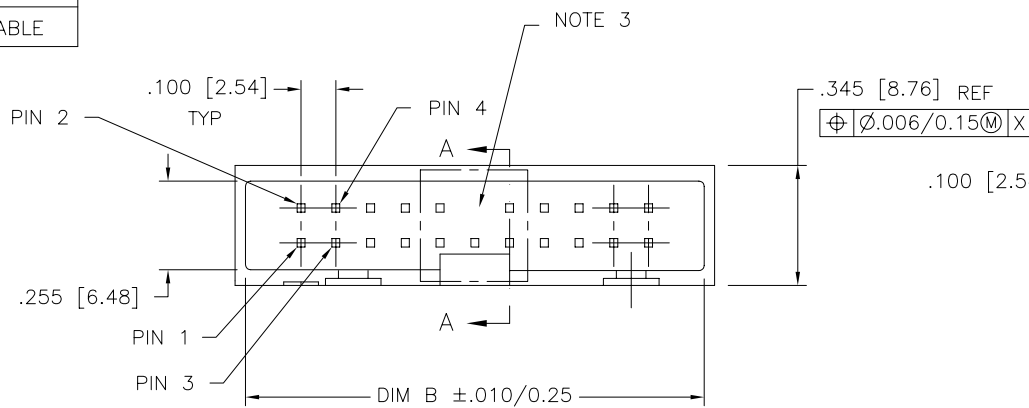
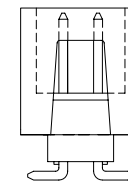
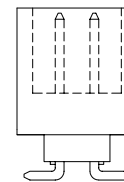
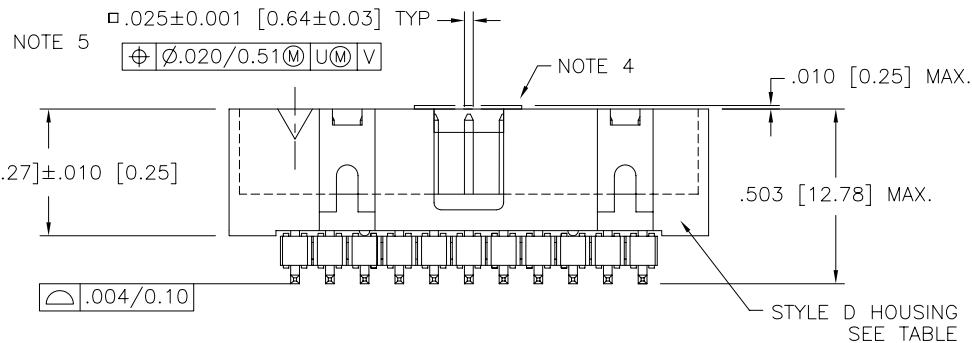

w/WINDOW OPTION
SEE TABLE

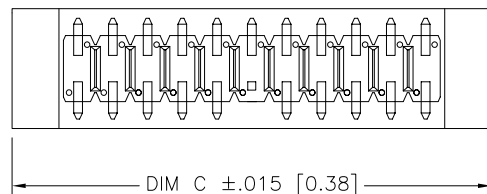

DRAWN WITHOUT WINDOW OPTION

| | | | | | | | | | | | |
|--------------------------------|----------|-----|----------|---|---------------------------------------|----------------------------------|------------------------|-------------------------------|--|--|--|
| mat'l. code SEE NOTES 1 & 2 | | | | surface ISO 1302 <input checked="" type="checkbox"/> | | tolerance ISO 406 ISO 1101 | projection | product family BERGSTIK | | | |
| ltr | ecr | no | dr | date | tolerances unless otherwise specified | | | title | | | |
| V | v12697 | GIP | 12/20/01 | | angles | linear | .XX $\pm .01/.3$ | BERGSTIK® II HDR. D/R | | | |
| W | v20439 | GIP | 3/05/02 | | | | .XXX $\pm .005/.13$ | SLIMLINE SMT ASSEMBLY | | | |
| X | v21301 | GIP | 6/17/02 | 0'±2' | | | .XXXX $\pm .0020/.051$ | scale 1:1 | | | |
| Y | v03-0476 | DAI | 6/17/03 | dr | E. KROPWIENICK | | 8/21/96 | | | | |
| AA | M05-0086 | ERE | 9/28/05 | enr | L. FYE | | 8/21/96 | | | | |
| AB | M06-0269 | MNR | 7/17/06 | chr | T. BREWBAKER | | 8/21/96 | | | | |
| AC | M06-0354 | MHT | 9/08/06 | app | T. BREWBAKER | | 8/21/96 | | | | |
| sheet | revision | AC | AC | AC | AC | | | dwg no | | | |
| index | sheet | 1 | 2 | 3 | 4 | | | 72454 | | | |
| | | | | | | | | type Product Customer Drawing | | | |

| PRODUCT NO SEE TABLE | PLATING CODE | CONTACT AREA PLATING | SOLDER TAIL PLATING |
|-------------------------|-----------------|-----------------------------------|------------------------------------|
| | AA | 30u"/.76u AU OVER 50u"/1.27u Ni | 100u"/2.54u TIN OVER 50u"/1.27u Ni |
| | 4 | 100u"/3.05u Sn OVER 50u"/1.27u Ni | 100u"/3.05u Sn OVER 50u"/1.27u Ni |

| LEAD FREE PLATING | AA | 30u"/.76u AU OVER 50u"/1.27u Ni | 100u"/2.54u TIN OVER 50u"/1.27u Ni |
|----------------------|----|-----------------------------------|------------------------------------|
| | 4 | 100u"/3.05u Sn OVER 50u"/1.27u Ni | 100u"/3.05u Sn OVER 50u"/1.27u Ni |

NOTE 11

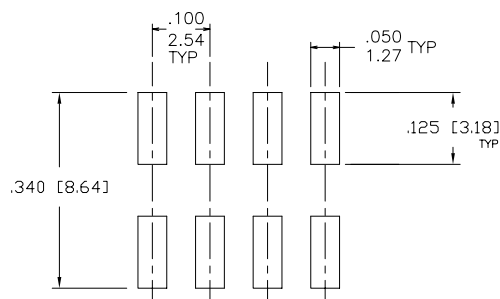

RECOMMENDED PAD LAYOUT
SCALE 4/1

NOTES:

1. BODY MATERIAL: PCT, GLASS FIBER REINFORCED, FLAME RETARDANT PER UL-94V-0.
COLOR: BLACK
2. PIN MATERIAL: PHOS-BRONZE.
3. PINS DELETED FROM SPECIFIED LOCATIONS FOR POLARIZATION. SEE TABLE FOR LOCATIONS.
4. PACKAGING OPTIONS: CHECK SPECIFIC PART NUMBERS FOR AVAILABILITY.
PART NUMBERS WITHOUT A SUFFIX ARE PACKAGED IN TRAYS.
PART NUMBERS FOLLOWED BY A "V" SUFFIX ARE PACKAGED TAPE-ON-REEL WITH A PICK-UP CAP INSTALLED. VACUUM CAP TO BE CENTRALLY LOCATED REGARDLESS OF NUMBER OF POSITIONS.
PART NUMBERS FOLLOWED BY A "B" SUFFIX ARE ASSEMBLED WITH VACCUM PICK-UP CAPS INSTALLED AND PACKAGED IN TRAYS
5. MEASURED WITH PART IN RESTRAINED CONDITION.
6. TWO SIDES OF PIN TIPS NOT PLATED. TYPICAL BOTH ENDS (SIMPLEX PLATING ONLY).
7. 2 LBS/0.9KG MIN PIN RETENTION IN EITHER DIRECTION.
8. ADD "LF" SUFFIX AT THE END OF PART NUMBER FOR LEAD FREE OPTION.
9. THIS PRODUCT MEETS EUROPEAN UNION DIRECTIVES AND OTHER COUNTRY REGULATION AS DESCRIBED IN GS-22-008.
10. THE HOUSING WILL WITHSTAND EXPOSURE TO 260°C PEAK TEMPERATURE FOR 10-20 SECONDS IN A CONVECTION, INFRA-RED OR VAPOR PHASE REFLOW OVEN. SEE APPLICATION NOTES/PROCEDURES IF THEY ARE AVAILABLE.
11. "THIS PRODUCT HAS 100% TIN PLATING IN THE INTERFACE AND HAS NOT BEEN TESTED FOR WHISKER GROWTH IN ALL INTERCONNECT ENVIRONMENTS."

| | | | | |
|--------------------------------|---------------------------------------|---|-----------------------|---|
| mat'l. code SEE NOTES 1 & 2 | surface ISO 1302 ✓ | tolerance ISO 406 ISO 1101 | projection INCH/MM | product family BERGSTIK |
| ltr ecn no dr date | tolerances unless otherwise specified | | | title BERGSTIK® II HDR. D/R SLIMLINE SMT ASSEMBLY |
| AC | angles linear | .XX±.01/.3 .XXX±.005/.13 .XXXX±.0020/.051 | scale 1:1 | dwg no 72454 |
| | dr E. KROPWIENICKI 8/21/96 | | | sheet 2 of 4 size A3 |
| | enr L. FYE 8/21/96 | | | |
| | chr T. BREWBAKER 8/21/96 | | | |
| | app T. BREWBAKER 8/21/96 | | | |
| sheet index | revision sheet | | | type Product Customer Drawing |



FCIconnect.com

Copyright FCI

form: A3

PRODUCT NO
SEE TABLE

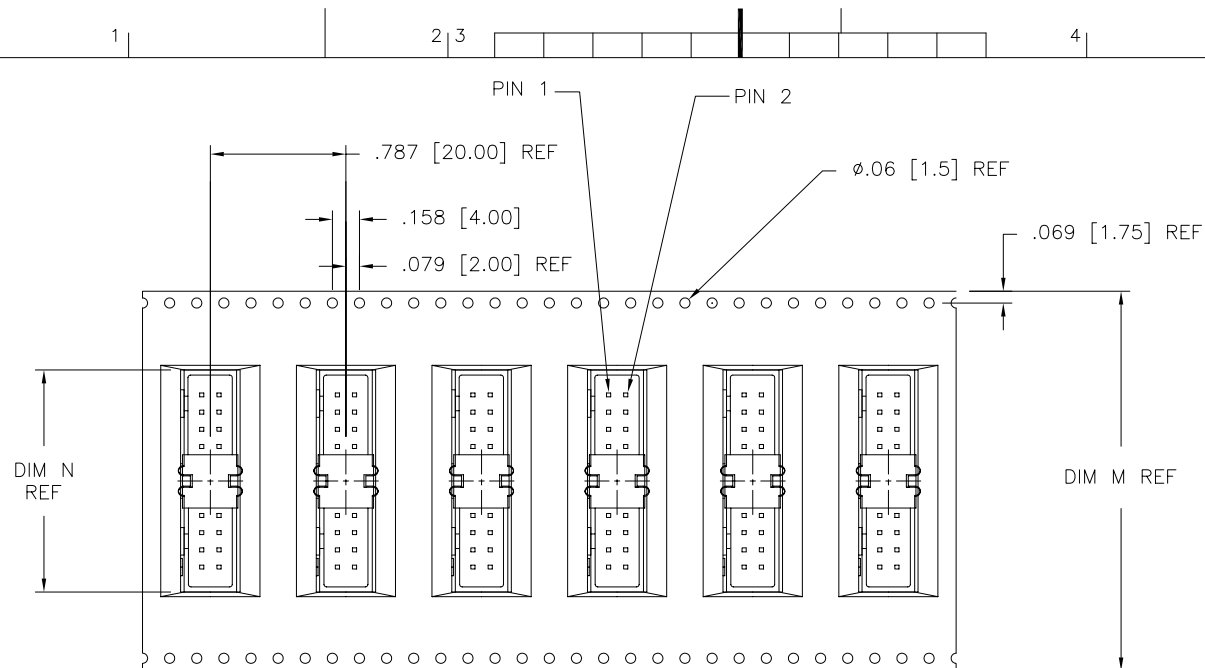

UN-REELING DIRECTION OF FEED

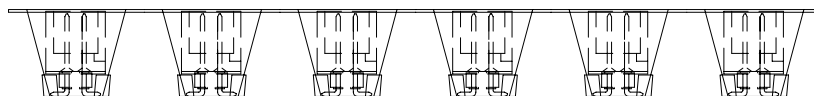

| | | | | | |
|-------------|----------------|----------|--------------|------------|---|
| mat'l. code | | surface | tolerance | projection | product family |
| - | | ISO 1302 | ISO 406 | | BERGSTIK |
| - | | ISO 1101 | ISO 1101 | | |
| ltr | ecn no | dr | date | INCH/MM | title |
| AC | | | | | BERGSTIK® II HDR. D/R SLIMLINE SMT ASSEMBLY |
| | | | angles | linear | scale 1:1 |
| | | | 0°±2' | | |
| | | dr | T. BREWBAKER | 5/18/98 | dwg no |
| | | enr | M.SMYK | 5/18/98 | sheet 3 of 4 size |
| | | chr | M.SMYK | 5/18/98 | A3 |
| | | appd | M.SMYK | 5/18/98 | type |
| sheet index | revision sheet | | | | Product Customer Drawing |



FCIconnect.com

Copyright FCI

form: A3

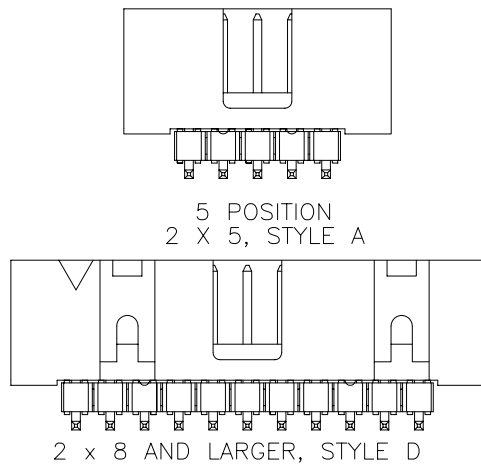

| PRODUCT NUMBER | NO. OF POSITIONS | DIM B | DIM C | STYLE | POLARIZED POSITION | WINDOW OPTION | PLATING CODE | PACKAGING | TAPE WIDTH DIM M | POCKET DEPTH | DIM N | LEAD FREE OPTION |
|----------------|------------------|-------------|-------------|-------|--------------------|---------------|--------------|--------------|------------------|--------------|-------------|------------------|
| 72454-008 | 2 X 4 | .610/15.50 | .690/15.33 | A | — | N | AA | TRAY | — | — | — | NOTE 8,9 |
| 72454-010 | 2 X 5 | .710/18.03 | .790/20.07 | A | — | N | AA | TRAY | — | — | — | |
| 72454-010V | 2 X 5 | .710/18.03 | .790/20.07 | A | — | N | AA | TAPE ON REEL | 1.260/32.00 | .515/13.08 | .790/20.07 | |
| 72454-014 | 2 X 7 | .910/23.11 | .99/25.2 | D | — | N | AA | TRAY | — | — | — | |
| 72454-016 | 2 X 8 | 1.010/25.65 | 1.090/27.69 | D | — | N | AA | TRAY | — | — | — | |
| 72454-016V | 2 X 8 | 1.010/25.65 | 1.090/27.69 | D | — | N | AA | TAPE ON REEL | 1.732/44.00 | .515/13.08 | 1.090/27.69 | |
| 72454-020 | 2 X 10 | 1.210/30.73 | 1.290/32.77 | D | — | N | AA | TRAY | — | — | — | |
| 72454-020V | 2 X 10 | 1.210/30.73 | 1.290/32.77 | D | — | N | AA | TAPE-ON-REEL | 2.205/56.00 | .505/12.83 | 1.290/32.77 | |
| 72454-021 | 2 X 11 | 1.310/33.27 | 1.390/35.31 | D | 12 | N | AA | TRAY | — | — | — | |
| 72454-022 | 2 X 11 | 1.310/33.27 | 1.390/35.31 | D | — | N | AA | TRAY | — | — | — | |
| 72454-024 | 2 X 12 | 1.410/35.81 | 1.490/37.9 | D | — | N | AA | — | — | — | — | |
| 72454-024V | 2 X 12 | 1.410/35.81 | 1.490/37.9 | D | — | N | AA | TAPE-ON-REEL | 2.205/56.00 | .515/13.08 | 1.490/37.85 | |
| 72454-026 | 2 X 13 | 1.510/38.35 | 1.590/40.39 | D | — | N | AA | TRAY | — | — | — | |
| 72454-030 | 2 X 15 | 1.710/43.43 | 1.790/45.47 | D | — | N | AA | TRAY | — | — | — | |
| 72454-034 | 2 X 17 | 1.910/48.51 | 1.990/50.60 | D | — | N | AA | TRAY | — | — | — | |
| 72454-040 | 2 X 20 | 2.210/56.13 | 2.290/58.17 | D | — | N | 4 | TRAY | — | — | — | |
| 72454-041 | 2 X 20 | 2.210/56.13 | 2.290/58.17 | D | — | N | AA | TRAY | — | — | — | |
| 72454-044 | 2 X 22 | 2.410/61.21 | 2.490/63.25 | D | — | N | AA | TRAY | — | — | — | |
| 72454-050 | 2 X 25 | 2.710/68.83 | 2.790/70.87 | D | — | N | AA | TRAY | — | — | — | |
| 72454-051 | 2 X 10 | 1.210/30.73 | 1.290/32.77 | D | — | Y | AA | TRAY | — | — | — | |
| 72454-051V | 2 X 10 | 1.210/30.73 | 1.290/32.77 | D | — | Y | AA | TAPE-ON-REEL | 2.205/56.00 | .505/12.83 | 1.290/32.77 | |
| 72454-052 | 2 X 20 | 2.210/56.13 | 2.290/58.17 | D | 20 | N | AA | TRAY | — | — | — | NOTE 8,9 |
| 72454-053V | 2 X 5 | 0.710/18.03 | 0.790/20.07 | A | 9 | N | AA | TAPE ON REEL | 1.260/32.00 | .515/13.08 | .790/20.07 | |

| | | | | | | | |
|-------------|----------------|----|----|------------|---|------------|--|
| mat'l. code | | | | surface | tolerance | projection | product family |
| — | | | | ISO 1302 ✓ | ISO 406 ISO 1101 | ⊕ | BERGSTIK |
| ltr | ecn | no | dr | date | tolerances unless otherwise specified | INCH/MM | title |
| AC | | | | | angles linear .XX±.01/.3 .XXX±.005/.13 .XXXX±.0020/.051 | scale 1:1 | BERGSTIK® II HDR. D/R SLIMLINE SMT ASSEMBLY |
| | | | | | dr T. BREWBAKER 5/18/98 | FCI | dwg no sheet 4 of 4 size |
| | | | | | enr M. SMYK 5/18/98 | | 72454 A3 |
| | | | | | chr M. SMYK 5/18/98 | | type Product Customer Drawing |
| | | | | | appd M. SMYK 5/18/98 | | |
| sheet index | revision sheet | | | | | | |