

PRODUCT NO.

61729

PRODUCT NUMBER CODE

61729- X 0 X X X P S LF

BASE PRODUCT NUMBER

HOUSING COLOR OPTION

0 - WHITE

1 - BLACK

SHIELD OPTION

1 - FULL BACK

2 - PARTIAL BACK

S - FULL BACK (SPECIAL MATERIAL
FOR 12,000 DURABILITY CYCLES)P - PARTIAL BACK (SPECIAL MATERIAL
FOR 12,000 DURABILITY CYCLES)

TERMINAL PLATING OPTION

0 - 50u" NI UNDERPLATED

30U" GXT CONTACT AREA

100u" PURE TIN TAIL AREA

1 - 50u" NI UNDERPLATED

30U" GOLD CONTACT AREA

100u" PURE TIN TAIL AREA

PACKAGING OPTION

B-TUBES

R-TAPE & REEL

DATE CODE OPTION

ONLY FOR PANASONIC

LEAD FREE OPTION

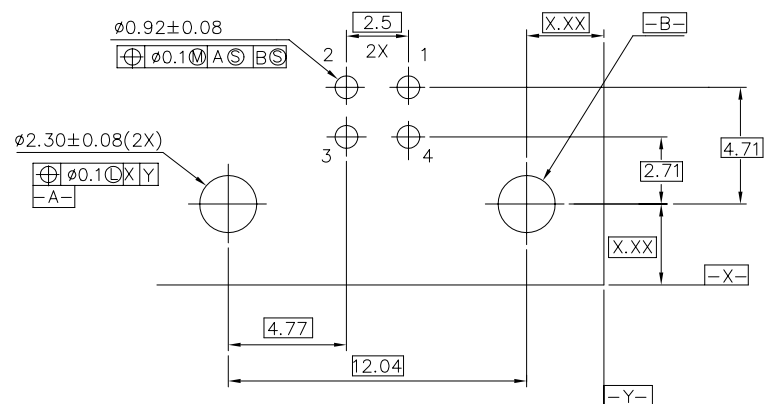
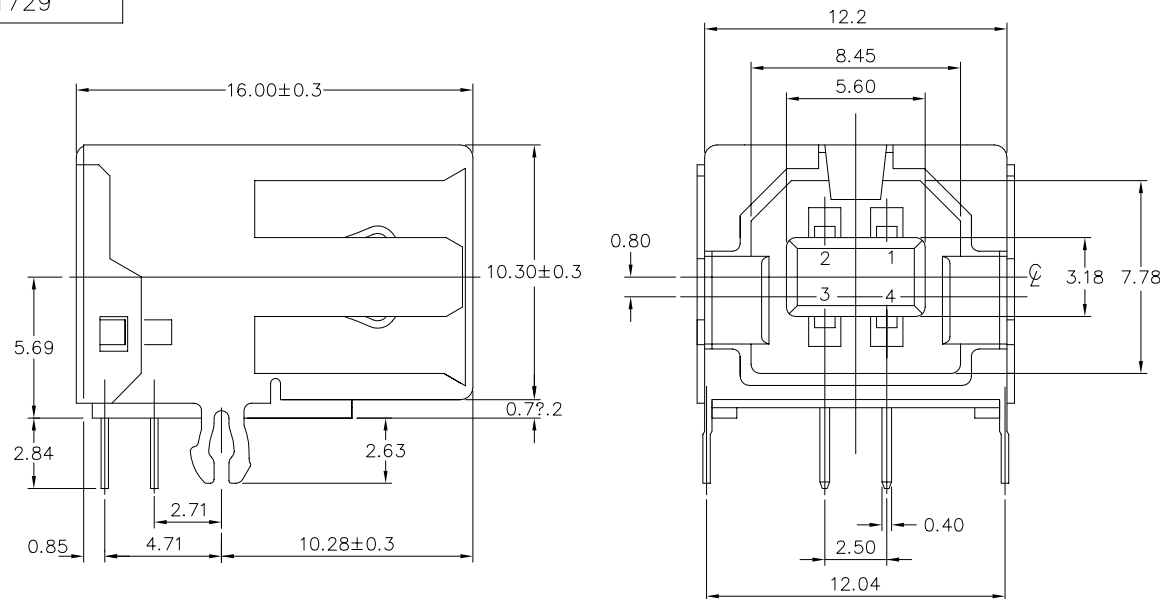

mat'l. code				tolerances unless otherwise specified		CUSTOMER COPY		FCI		www.fciconnect.com	
ltr	ecn no	dr	date	linear	.0 ± 0.30	projection	title	product family	code	size	sheet
S	N05-0242	PH	08/22/05		.00 ± 0.20						
T	N06-0103	HB	04/15/06	angles	.000 ± 0.10	MM/INCH	USB RECEPTACLE B TYPE	USB	61729	A3	1 of 2
U	N08-0238	R.B	2008/11/03		± 2°						
V	N08-0264	R.B	2008/12/08	dr	SHIRLEY HSU	03/03/97	scale	4 : 1	A3	61729	1 of 2
				enr	R Y LIU	03/03/97					
				chr	R Y LIU	03/03/97	scale	4 : 1	A3	61729	1 of 2
				appd	JENN TSAO	03/03/97					
sheet	revision										
index	sheet										

PDM: Rev:V

STATUS: Released

Printed: Dec 10, 2008

6

PRODUCT NO.

61729

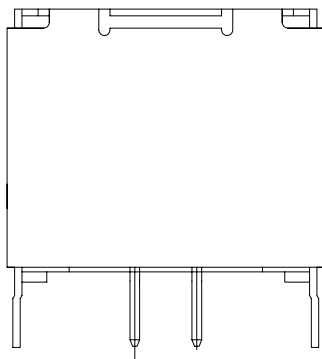

TYPE"1" FULL BACK

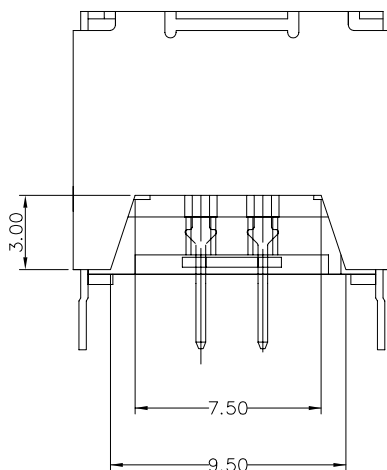

TYPE"2" PARTIAL BACK

NOTES:

1. MATERIAL:
SHIELD & CONTACTS: COPPER ALLOY
HOUSING: UL 94V-0 THERMOPLASTIC. COLOR: SEE PRODUCT NUMBER CODE.
2. PLATING: SEE PRODUCT NUMBER CODE.
SHIELD: BRIGHT TIN
NICKEL UNDERPLATE.
3. DATUMS & BASIC DIMENSIONS TO BE DETERMINED BY CUSTOMER
4. RECOMMENDED BOARD THICKNESS IS 1.57 mm (.062)
5. PACKING STANDARD GS-14-920 WILL BE APPLIED FOR LEAD FREE P/N'S
6. FOR LEAD FREE P/N, THE PRODUCT MEET EUROPEAN UNION DIRECTIVES AND OTHER COUNTRY REGULATION AS DESCRIBED IN GS-22-008
7. FOR LEAD FREE P/N'S, THE HOUSING WILL WITHSTAND EXPOSURE TO 260°C PEAK TEMPERATURE FOR 40 SECONDS IN A CONVECTION, INFRARED OR VAPOR PHASE REFLOW OVEN.
8. THE PART CAN BE USED FOR PIP PROCESS.

mat'l. code				tolerances unless otherwise specified		CUSTOMER COPY		FCI		www.fciconnect.com	
ltr	ecr no	dr	date	linear	.0 ± 0.20	projection	title	product family	code	size	sheet
v					.00 ± 0.10						
					.000 ± 0.05						
				angles	± 2°						
				dr	SHIRLEY HSU 03/03/97	MM/INCH		USB			
				enr	R Y LIU 03/03/97			RECEPTACLE B TYPE			
				chr	R Y LIU 03/03/97	scale					
				appd	JENN TSAO 03/03/97	5 : 1					
sheet	revision										
index	sheet										

PDM: Rev:V

STATUS: Released

Printed: Dec 10, 2008

6