

IEC appliance inlet C8, screw-on mounting, rear side, PCB-/solder terminal



Screw-On Version

**Description**

- Panel Mount:
Screw-on from rear-side
- Appliance Inlet, Pin temperature 70 °C, Protection class II
- PCB

Approvals

- VDE License Number: 40017311
- UL License Number: E96454
- CSA License Number: 73165

Weblinks

[Approvals](#), [RoHS](#), [CHINA-RoHS](#), [e-Store](#), [SCHURTER-Stock-Check](#), [Distributor-Stock-Check](#)

Technical Data

Ratings IEC	2.5 A / 250 VAC; 50 Hz
Ratings UL/CSA	2.5 A / 250 VAC; 60 Hz
Dielectric Strength	> 2 kVAC between L-N (1 min/50 Hz)
Allowable Operation Temp.	-25 °C to 70 °C
Degree of Protection	from rear-side IP 40 acc. to IEC 60529
Protection Class	Suitable for appliances with protection class II acc. to IEC 61140
Terminal	PCB solder terminals
Panel Thickness s	Screw-on: max 4 mm Mounting screw torque max 0.5 Nm
Material: Housing	Thermoplastic, black, UL 94V-0

Appliance-Inlet/-Outlet	C8 acc. to IEC/EN 60320-1, UL 498, CSA C22.2 no. 42 (for cold conditions) pin-temperature 70 °C, 2.5 A, Protection class II
-------------------------	---

Dimensions

0720-FP

Length |—————| 35 mm

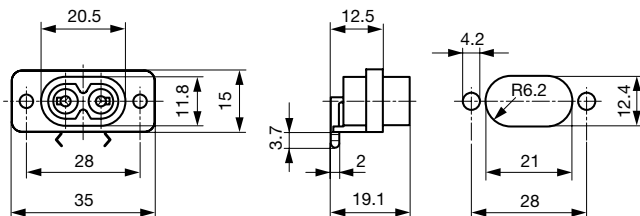

Solder terminals for PCB

Drilling diagrams

PCB Layout

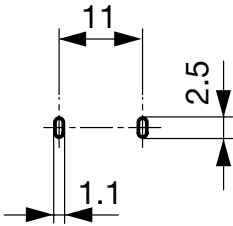

Variants

[Distributor-Stock-Check](#) | [SCHURTER-Stock-Check](#) | [e-Store](#)

Type	Panel mounting	Panel Thickness s [mm]	Terminal	Order Number
0720-FP	Screw-on	-	PCB solder terminals	4300.0097

Packaging unit

50 Pcs

Mating Outlets/Connectors

Category / Description

Power Supply or Interconnection Cord



Power Cord with IEC Appliance Plug C7, straight 70°C	2510
Power Cord with IEC Appliance Plug C7, angled, 70°C	2511
Power Cord with IEC Appliance Plug C7, angled, 70°C	2514
Power Cord with IEC Appliance Plug C7, straight 70°C	4810
Power Cord with IEC Appliance Connector C7, Line Plug Continental Europe, 70°C	CS01.0121.150
Power Cord with IEC Appliance Connector C7, Line Plug North America, 70°C	CS01.0221.150
Power Cord with IEC Appliance Connector C7, Line Plug Switzerland, 70°C	CS01.0321.150
Power Cord with IEC Appliance Connector C7, Line Plug UK, 70°C	CS01.0421.150
	CS03.0421.150
	CS03.0521.150
	...