

# Top View of Assembly

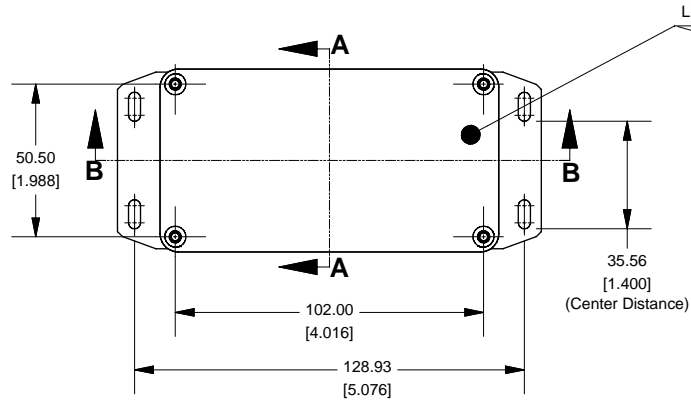

# SECTION A-A End View of Assembly

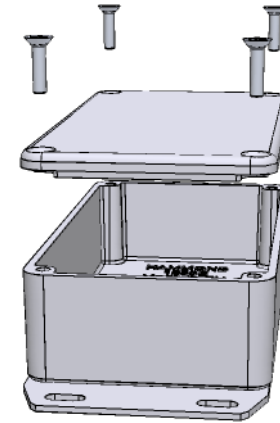
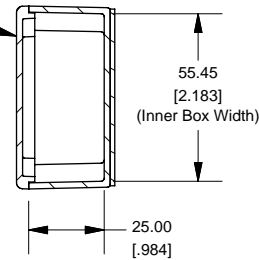

# SECTION B-B Side View of Assembly

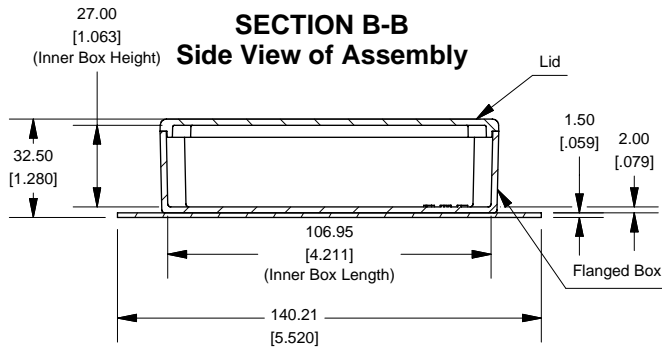

# Top View Looking Inside Box

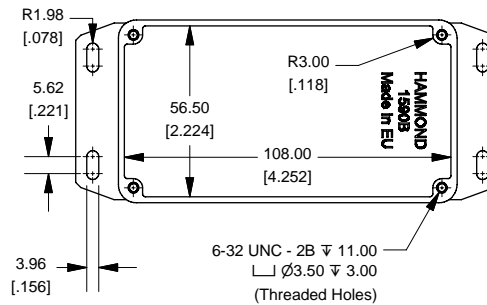

Enclosures can be Factory Modified ( Milling, Drilling, Printing etc.)  
Contact Factory [mjm@hammondmfg.com](mailto:mjm@hammondmfg.com) for quotes  
Solid models of this enclosure available in STEP or IGES.

**NOTE**  
Purchased assembly includes box, lid and 4 cover screws.  
Box and lid are made from Diecast Aluminum Alloy (alloy type 380).  
Silicone Gasket Loctite #5950  
Bottom Flange is Welded

## PART NUMBERS

1590BF Enclosure	
Unfinished	1590BF
Grey Textured Polyester Powder Paint - RAL 7038	1590BFGY
Black Textured Polyester Powder Paint - RAL 9011	1590BFBK
1590BF Liquid Resistant Enclosure (Silicon Factory Installed Gasket)	
Unfinished	1590WBF
Black Textured Powder Paint	1590WBFBK

## ACCESSORIES

Recommended Torque: 75 ozf.in / 55 cN.m

Black Textured Cover Screws (Pkg 50) [6-32 x 1/2" SS Type 304]	1590WMS100BK
Unfinished Cover Screws (Pkg 100) [6-32 x 1/2" Nickel Plated Screws]	1590WMS100

## Standard Cover Screws

Unfinished Cover Screws (Pkg 100) [6-32 x 1/2" Nickel Plated Screws]	1590MS100
Black Textured Cover Screws (Pkg 50) [6-32 x 1/2" SS Type 304]	1590MS100BK

**HAMMOND  
MANUFACTURING™**  
**1590BF**  
[www.hammondmfg.com](http://www.hammondmfg.com)