

# Geartooth Speed Sensors



- ▶ [Back To Main Products Page](#)
- ▶ [Sensor News](#)
- ▶ [Sensor FAQs](#)
- ▶ [Operating a Speed Sensor](#)
- ▶ [Operating a Reed Sensor](#)
- ▶ [Technical Articles](#)
- ▶ [Find a Rep](#)
- ▶ [Ask a Question](#)
- ▶ [Application Help](#)
- ▶ [Request a Sample](#)
- ▶ [Request a Catalog](#)

Search Site

Check Distributor Stock

 

## GEARTOOTH SPEED AND DIRECTION SENSOR

Hall effect geartooth speed and direction sensor with adjustable stainless steel housing.

- Sense Motion/Direction of Ferrous Geartooth Targets
- Separate Digital Outputs for Speed and Direction
- Immune to Hostile Environments
- High-Speed Capability
- Operate From 5 to 24Vdc
- Reverse Battery Protection to -24Vdc
- Wide Operating and Storage Temperature Range
- M12 Integral Connector Meets IEC60947-5-2
- Meet all IEC (International Electrotechnical Commission) Requirements for Heavy Industrial Environments, Assuring Immunity from:
  - Electrostatic Discharge      -Conducted Energy
  - Electrical Transients        -Magnetic Field Energy
  - Radiated Electric Field

### SD1002-SD1004

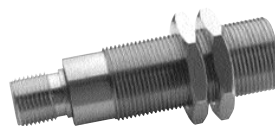

[download PDF](#)

## SD1002-SD1004 SPECIFICATIONS

Part #	Operating Voltage Range (VDC)	Supply Current mA max	Output	Output Saturation Voltage mV max	Output Current mA max	Operate Temp Range, C	Storage Temp Range, C	Housing	Thread	Barrel Length
SD100201	4.75 to 24	17	sink	400	25	-40 to 85	-40 to 105	SST	M18-1	65mm
SD100401	4.75 to 24	17	sink	400	25	-40 to 85	-40 to 105	SST	3/4" - 16	2.56"

### Notes:

For sensors with integral connectors, mating cordsets are available from Cherry. Request Part Number AS000203 for a straight female connector or AS000204 for a right-angle female connector.

### [Interface recommendations](#)

## OPEN COLLECTOR SINKING BLOCK DIAGRAM

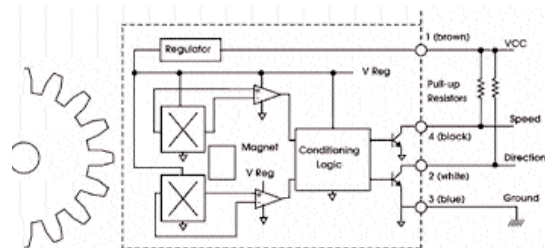

## DIMENSIONS

