



# FOR USE WITH PANDUIT® TYPE P SURFACE RACEWAY

## PAN-WAY™ TYPE P NON-METALLIC ROUTING SYSTEM SURFACE RACEWAY SYSTEM

PART NUMBERS: PD3, PD6, PTF, PICF, POCF, PRAF, PECF,  
PCF, PEEF36, PRJBX36

### INSTALLATION INSTRUCTIONS

©Panduit Corp. 1998

Made in U.S.A.

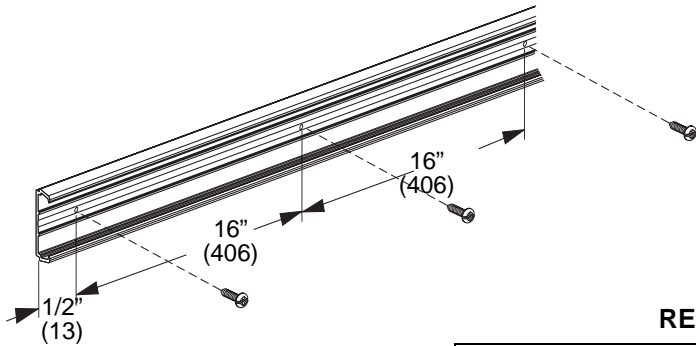

The mounting hardware used to secure the raceway shall be appropriate for the mounting surface.

### RECOMMENDED WIRE CAPACITIES

PART NUMBER	FILL CAPACITIES WITHOUT DEVICES					
	14 AWG		12 AWG		10 AWG	
	THHN/T90	THW/TW	THHN/T90	THW/TW	THHN/T90	THW/TW
PD3	5	4	4	3	-	-
PD6	10	6	7	4	5	4

### TEE FITTING

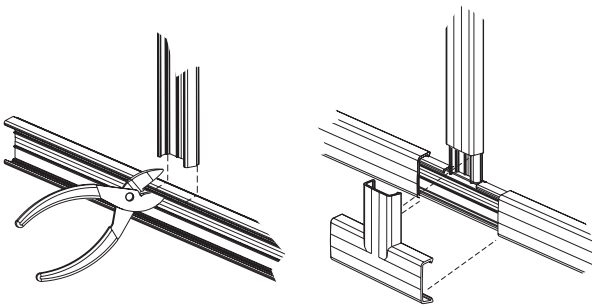

### INSIDE CORNER FITTING

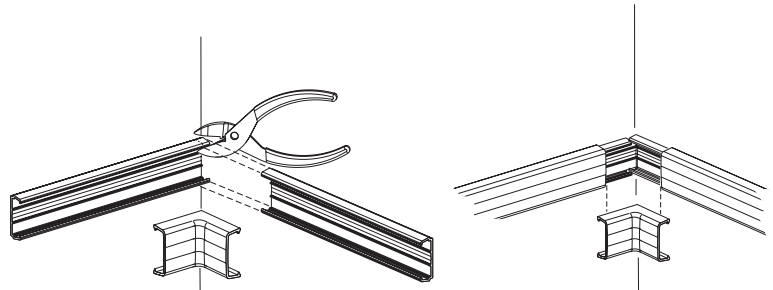

### OUTSIDE CORNER FITTING

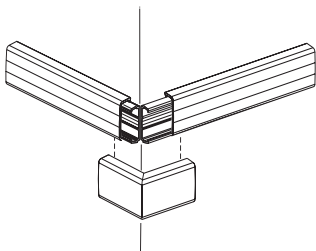

### RIGHT ANGLE FITTING

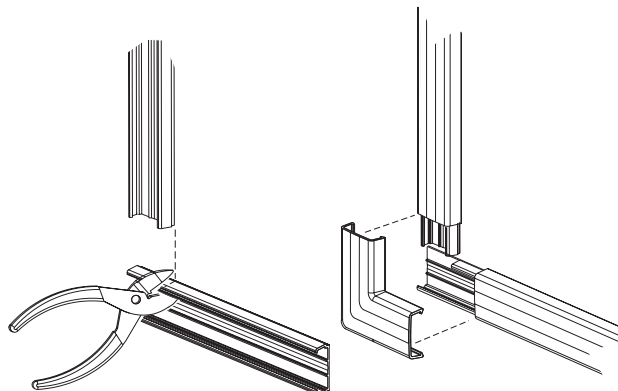

### END CAP

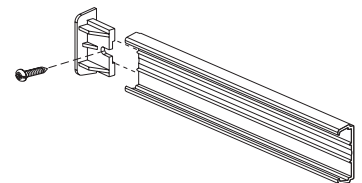

For Technical Assistance call: 888-506-5400, Ext. 8287

# TYPE P NON-METALLIC SURFACE RACEWAY INSTALLATION INSTRUCTIONS

## COUPLER FITTING

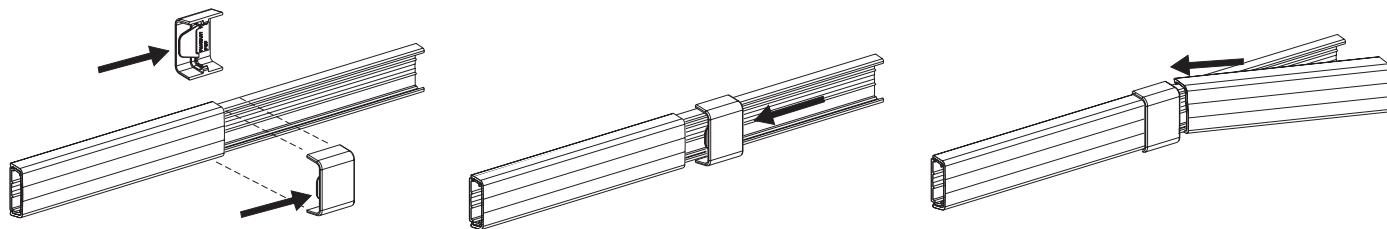

## ENTRANCE END FITTING

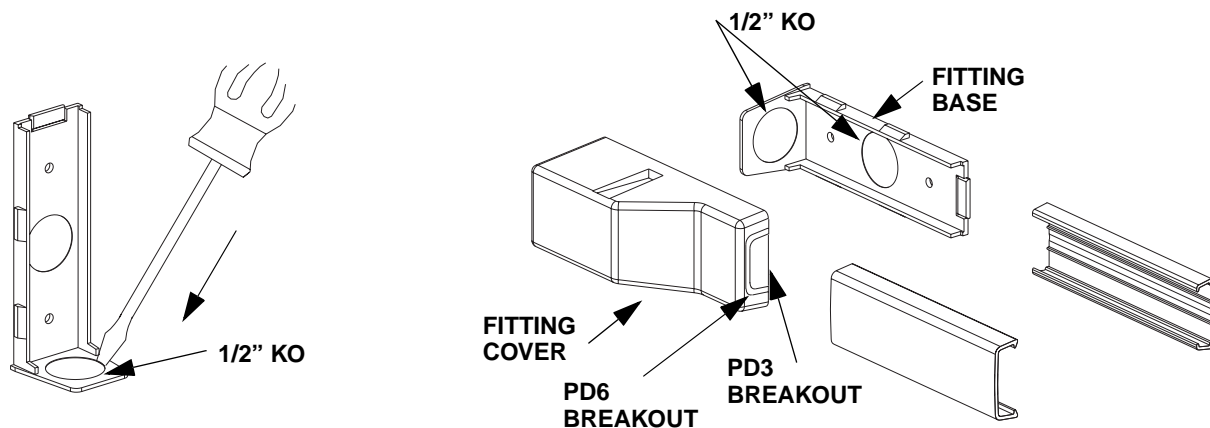

## POWER RATED ROUND JUNCTION BOX

**NOTE:** THE RECOMMENDED SCREW TO SECURE COVER TO BASE IS #8 - 32.

